



205 Godinton Road, Ashford

In Excess of **£285,000**

205 Godinton Road

Ashford, Ashford

Charming Victorian mid-terraced property in Ashford's Godinton Road. 3 beds, 2 receptions, stylish master bedroom, first-floor bathroom. Low-maintenance garden with decking, shed, and tranquil flower bed. No onward chain. Ideal for first-time buyers and investors.

Council Tax band: C

Tenure: Freehold

- Three Bedroom
- Two Reception Rooms
- Close Proximity To Ashford International Station
- Great Décor
- Enclosed Low Maintenance Rear Garden
- Popular Godinton Road Location
- Bay Fronted Victorian Property
- NO ONWARD CHAIN
- Master Bedroom With Wardrobes & Storage
- First Floor Bathroom



Hallway

With stairs to first floor and door leading to main living area.

Dining Room

15' 1" x 11' 6" (4.60m x 3.51m)

With window to rear, under stairs recess and open plan to lounge area.

Lounge

12' 5" x 11' 6" (3.78m x 3.51m)

Bay fronted with window to front.

Kitchen

10' 4" x 7' 11" (3.15m x 2.41m)

With range of white fronted cupboards and drawers beneath work surfaces, 2 windows to side, wall mounted boiler, 1 and half bowl stainless steel sink with mixer tap and 4 ring gas hob with extractor fan over and low level oven. Door way through to rear lobby.

Rear lobby

With door to garden and cupboard.

Landing

With storage cupboard and loft access.

Bedroom

14' 7" x 11' 2" (4.45m x 3.40m)

Built in mirrored wardrobes and 2 windows to front.

Bedroom

12' 5" x 9' 2" (3.78m x 2.79m)

Window to rear

Bedroom

7' 9" x 7' 11" (2.36m x 2.41m)

With window to rear.



Bathroom

White suite comprising low level wc, pedestal wash had basin, p-shaped bath with mixer tap, shower screen and shower over, obscured window to side and heated towel radiator.

Garden

Low maintenance rear garden mostly paved with decking area and shrub & flower bed, timber shed for storage.





Ground Floor

Approx. 43.2 sq. metres (465.5 sq. feet)

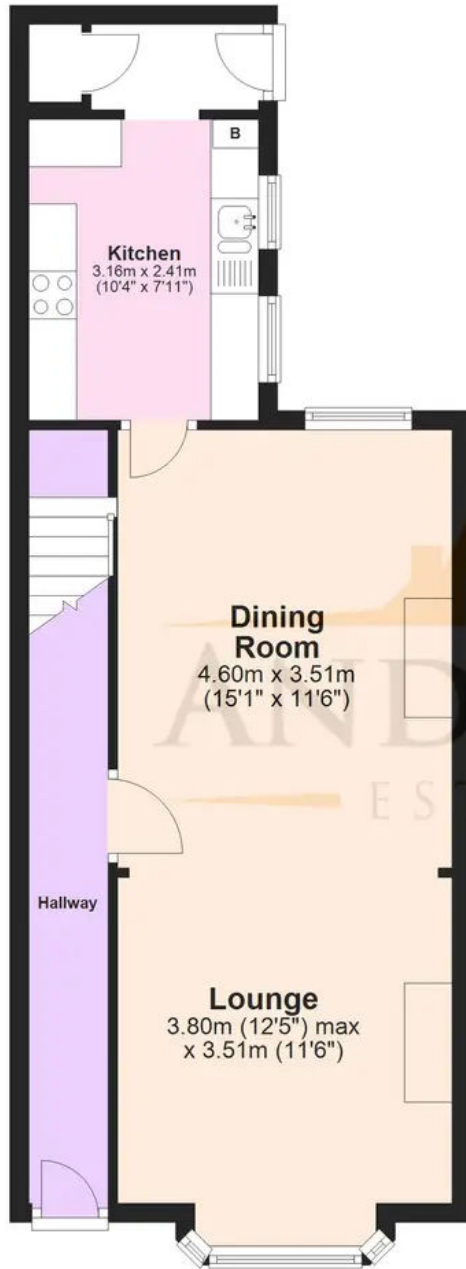

First Floor

Approx. 42.8 sq. metres (461.1 sq. feet)



Total area: approx. 86.1 sq. metres (926.6 sq. feet)

Plans are for layout purposes only and are not drawn to scale, with any doors, windows and other internal features merely intended as a guide.
Plan produced using PlanUp.

These particulars are intended to give a fair and reliable description of the property but no responsibility for any inaccuracy or error can be accepted and do not constitute an offer or contract. We have not tested any services or appliances (including central heating if fitted) referred to in these particulars and purchasers are advised to satisfy themselves as to the working order and condition, if a property is unoccupied at any time there may be reconnection charges for any switched off/disconnected or drained services or appliances. All measurements are approximate.

Andrew & Co Estate Agents - Ashford

01233 632383

info@andrewandco.co.uk

