



Pippin Close, New Romney

New Romney

£525,000



## Pippin Close

New Romney, New Romney

Charming 5-year-old townhouse in New Romney with modern kitchen/family room, landscaped garden, 2 en-suites, garage, and NHBC guarantee. Peaceful cul-de-sac location near High Street and local amenities. Ideal family home - book a viewing now!  
Council Tax band: D

Tenure: Freehold

EPC Energy Efficiency Rating: B

EPC Environmental Impact Rating: B

- Luxury Home
- Four Bedroom
- Kitchen Family Room
- Large Lounge
- Open Country View
- Landscaped Rear Garden
- Dining Room / Study
- Cul de Sac Location

**Entrance Hall**

7' 6" x 16' 10" (2.28m x 5.14m)

**Kitchen/Family Room**

17' 4" x 17' 7" (5.28m x 5.37m)

**Dining Room/Office**

12' 2" x 12' 4" (3.71m x 3.75m)

**Wc**

9' 7" x 4' 5" (2.91m x 1.35m)

**Landing****Living Room**

17' 4" x 17' 5" (5.29m x 5.31m)

**Bedroom**

17' 5" x 9' 9" (5.31m x 2.98m)

**En-Suite Shower Room**

7' 2" x 5' 4" (2.19m x 1.62m)

**Landing****Bedroom**

17' 5" x 14' 11" (5.30m x 4.56m)

**En-Suite Shower Room**

4' 9" x 9' 1" (1.44m x 2.78m)

**Family Bathroom**

9' 8" x 9' 1" (2.95m x 2.78m)

**Bedroom**

9' 1" x 12' 6" (2.77m x 3.82m)

**Bedroom**

7' 10" x 9' 10" (2.40m x 3.00m)





## Ground Floor

Approx. 56.0 sq. metres (602.4 sq. feet)

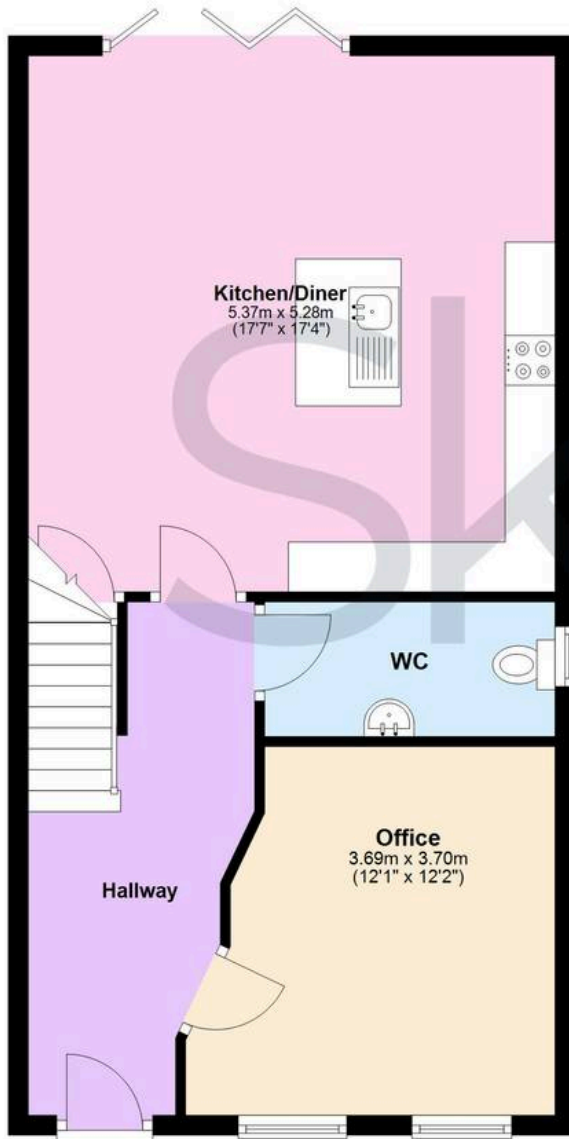

## First Floor

Approx. 56.5 sq. metres (608.1 sq. feet)

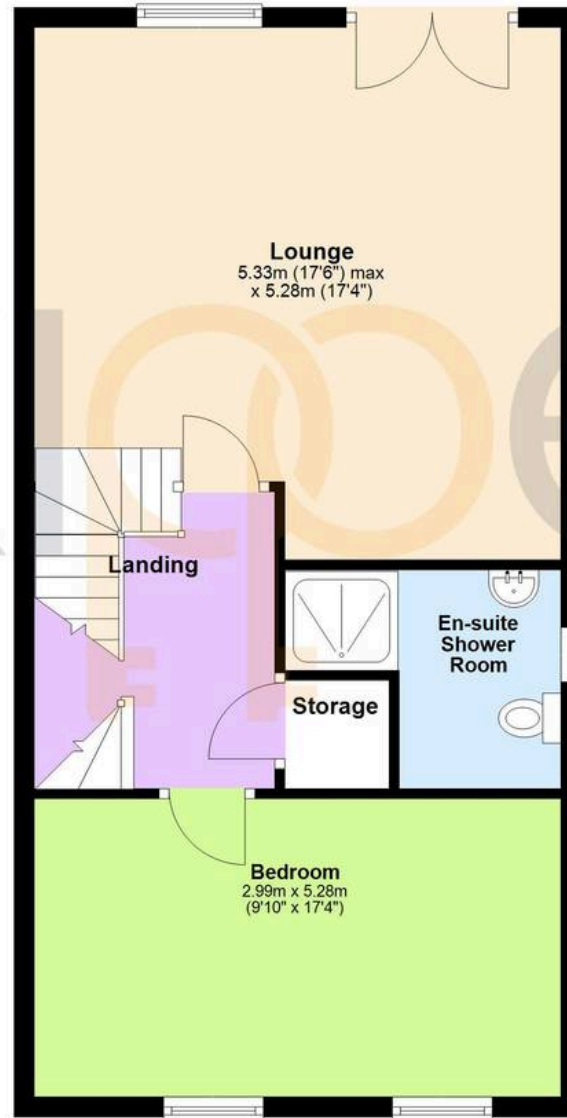

## Second Floor

Approx. 58.9 sq. metres (634.5 sq. feet)

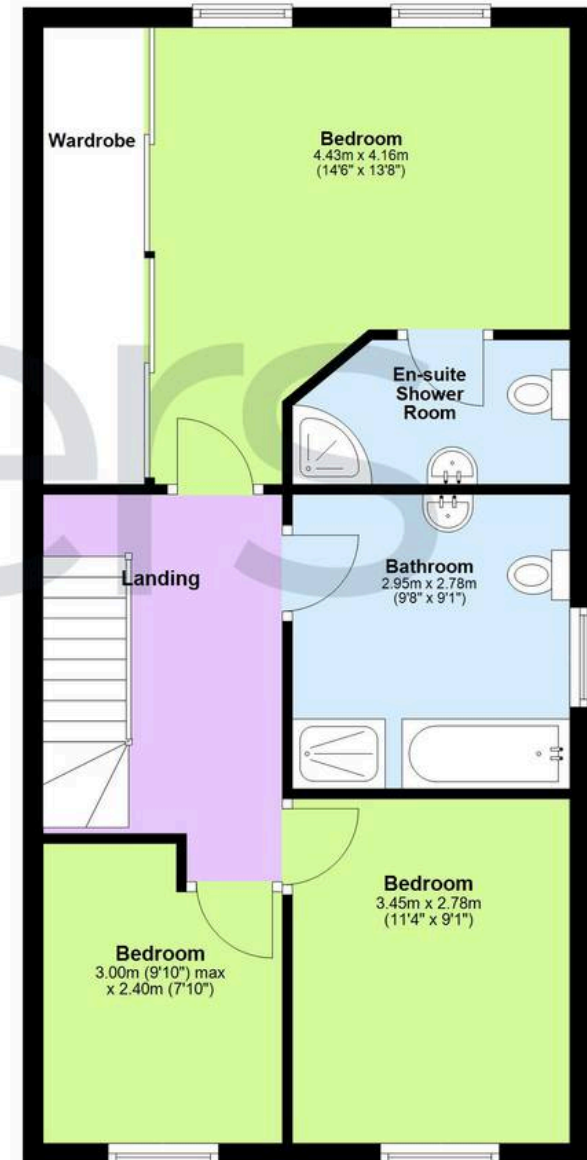

Total area: approx. 171.4 sq. metres (1845.1 sq. feet)



**Skippers Estate Agents New Romney**

55 High Street - TN28 8AH

01797 362898

**Skippers**