



34a Magazine Road, Ashford
£210,000

34a Magazine Road

Ashford, Ashford

A two-bedroom ground floor maisonette situated withing walking distance of Ashford Town Centre & International Station, with a secluded rear garden, off road parking and garage, available for sale with no onward chain.

Council Tax band: B

Tenure: Leasehold

- Two Bedroom Ground Floor Maisonette
- Walking distance to the Town Centre & International Station
- High Ceilings and Feature Fireplaces
- Off Road Parking and Garage at rear
- Secluded Rear Garden
- Ideal buy to let or fist time purchase



Entrance Hallway

Living Room
12' 10" x 12' 8" (3.92m x 3.85m)

Bedroom 1
11' 9" x 12' 8" (3.58m x 3.85m)

Inner Hallway

Bedroom 2
12' 2" x 6' 4" (3.71m x 1.93m)

Kitchen/Breakfast Room
10' 4" x 10' 9" (3.14m x 3.28m)

Bathroom



REAR GARDEN

GARAGE

Single Garage

DRIVEWAY

1 Parking Space

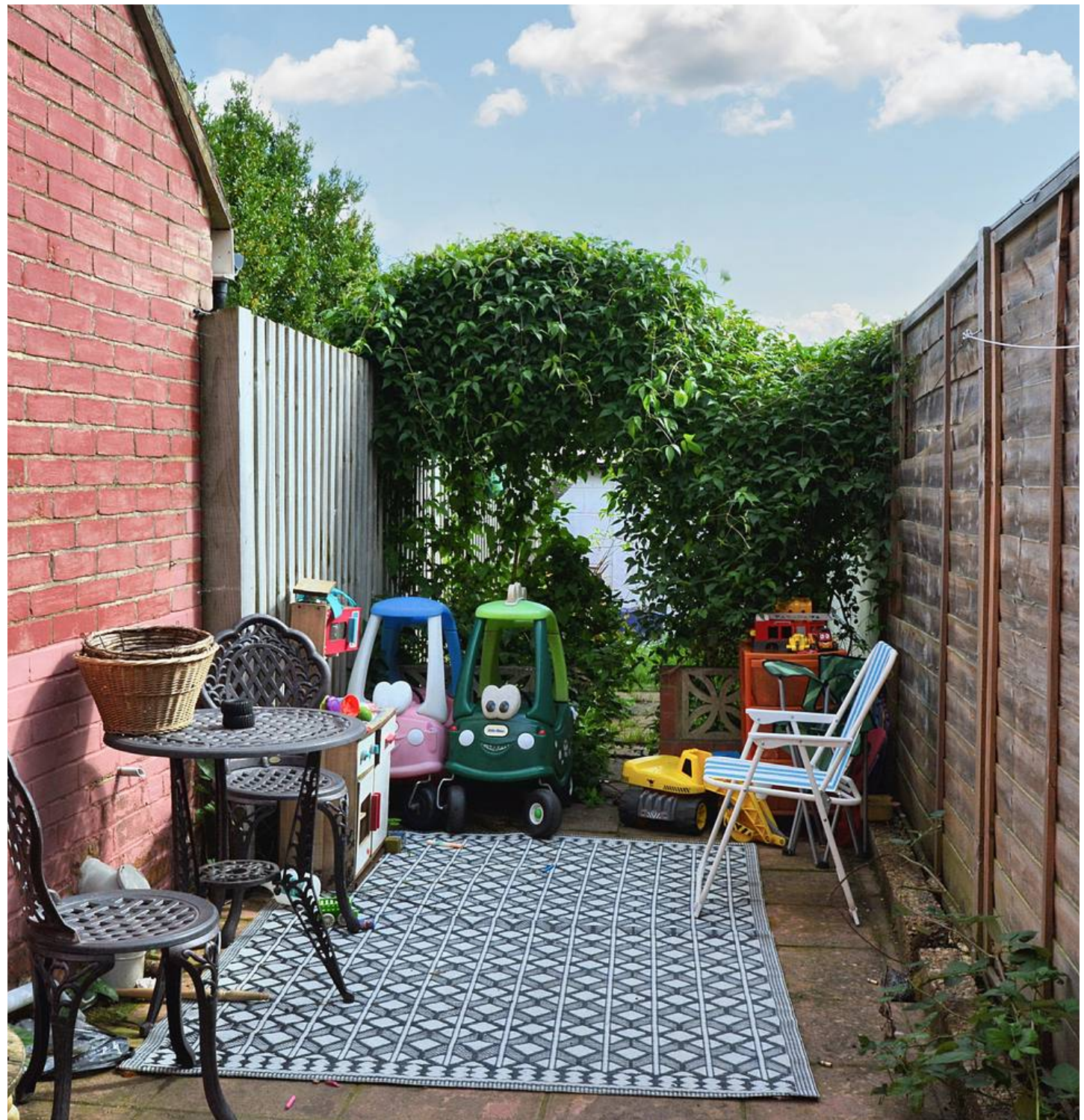

Ground Floor

Approx. 69.5 sq. metres (748.2 sq. feet)

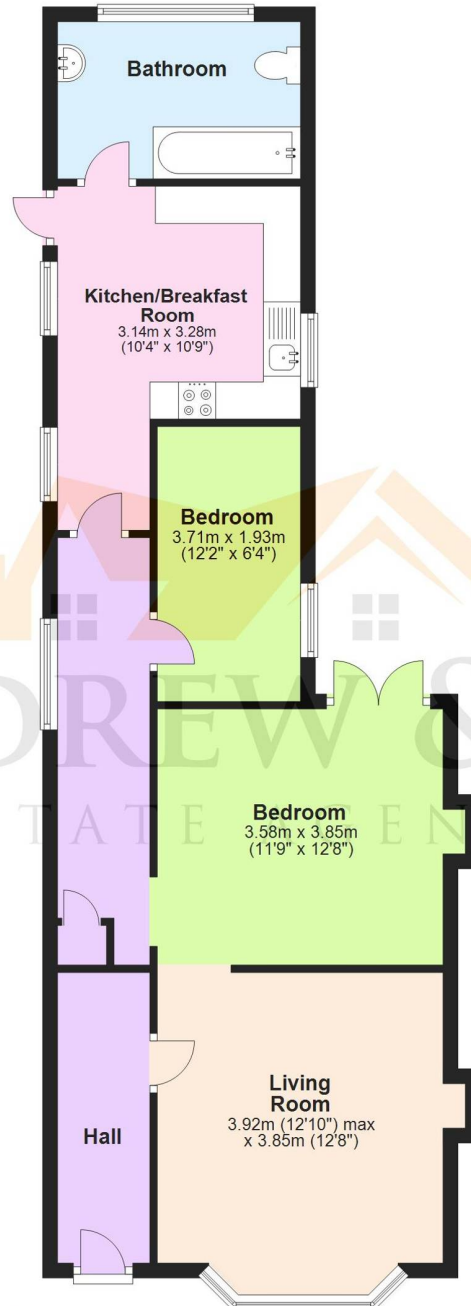

Total area: approx. 69.5 sq. metres (748.2 sq. feet)

Plans are for layout purposes only and are not drawn to scale, with any doors, windows and other internal features merely intended as a guide.
Plan produced using PlanUp.

These particulars are intended to give a fair and reliable description of the property but no responsibility for any inaccuracy or error can be accepted and do not constitute an offer or contract. We have not tested any services or appliances (including central heating if fitted) referred to in these particulars and purchasers are advised to satisfy themselves as to the working order and condition, if a property is unoccupied at any time there may be reconnection charges for any switched off/disconnected or drained services or appliances. All measurements are approximate.

Andrew & Co Estate Agents - Ashford

01233 632383

info@andrewandco.co.uk

