



Copperfields, Lydd

Romney Marsh

£275,000



36 Copperfields

Lydd, Romney Marsh

Delightful semi-detached family home in Lydd Romney Marsh. Modern features, 3 bedrooms, family bathroom, generous garden, garage, driveway for 3 cars. Close to town centre amenities. 827 sqft of space. Contact us for a viewing today!

Council Tax band: C

Tenure: Freehold

EPC Energy Efficiency Rating: C

EPC Environmental Impact Rating:

- Three Bedroom Home
- Large Living Room
- Modern Kitchen
- Family Home
- Popular Location
- Generous Garden
- Driveway Parking



Entrance Porch

Living Room

17' 0" x 14' 1" (5.18m x 4.30m)

Kitchen

8' 11" x 9' 0" (2.71m x 2.74m)

Landing

Bedroom

9' 5" x 12' 6" (2.87m x 3.82m)

Bedroom

11' 0" x 10' 0" (3.35m x 3.04m)

Bedroom

6' 9" x 8' 0" (2.06m x 2.45m)

Bathroom

6' 1" x 7' 3" (1.86m x 2.20m)



Ground Floor

Approx. 41.2 sq. metres (443.1 sq. feet)

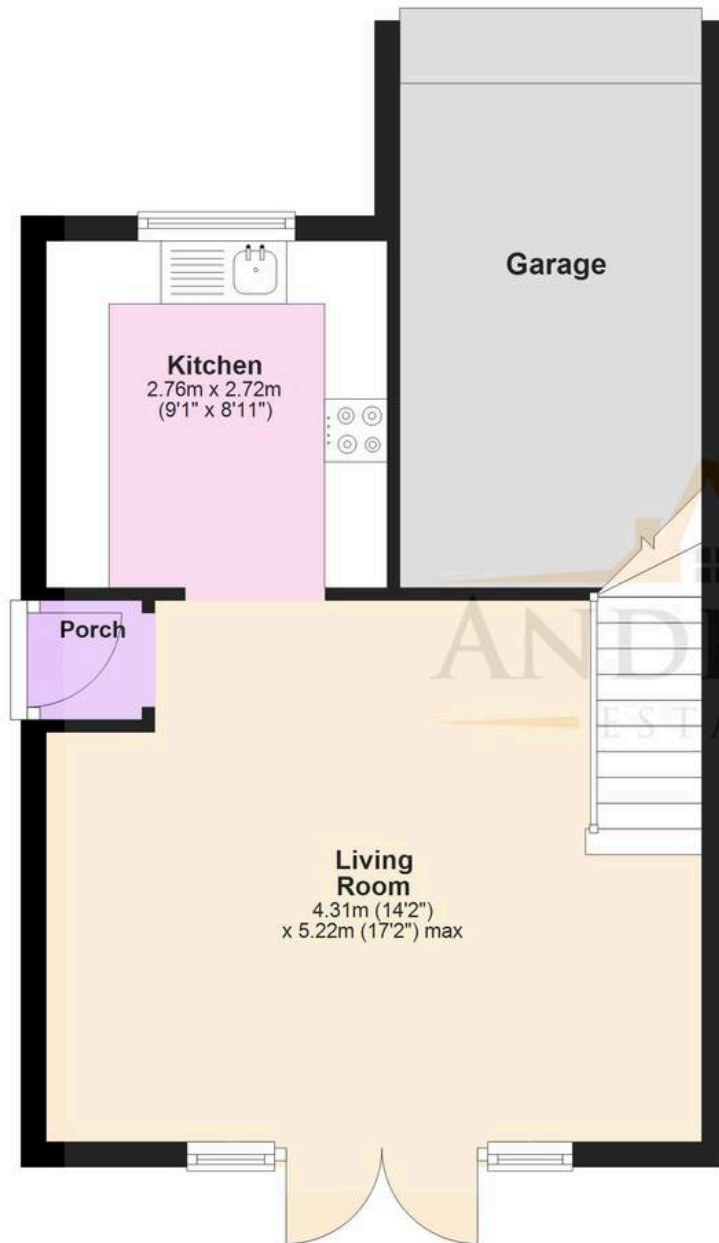

First Floor

Approx. 35.7 sq. metres (384.1 sq. feet)

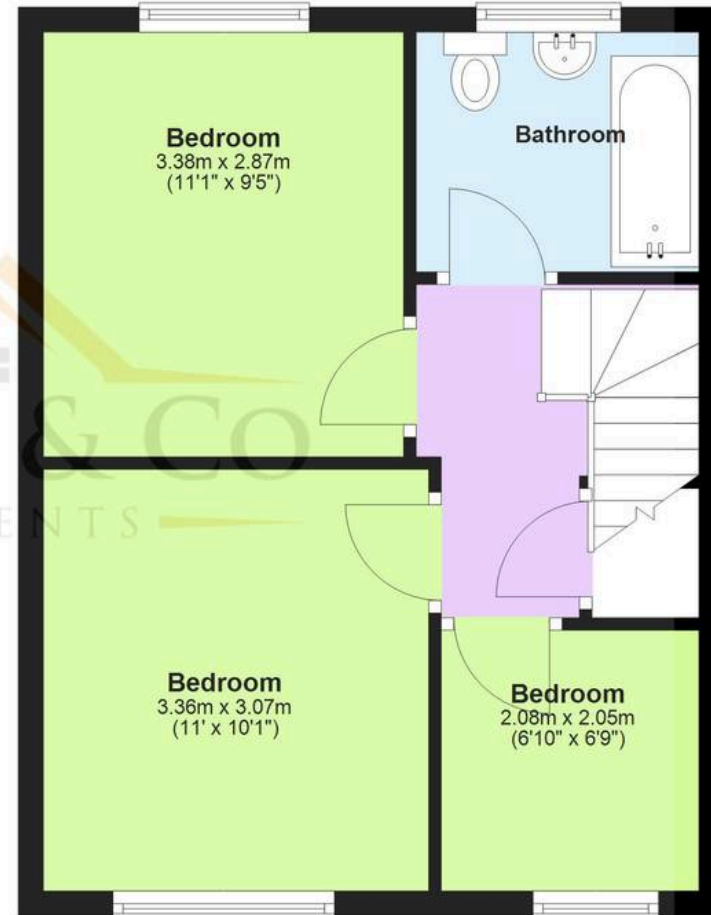

Total area: approx. 76.8 sq. metres (827.2 sq. feet)



Skippers Estate Agents New Romney

55 High Street - TN28 8AH

01797 362898

Skippers