



Marshall Terrace Bleak Road, Lydd

Romney Marsh

£285,000



3 Marshall Terrace Bleak Road

Lydd, Romney Marsh

Beautifully presented 3-bed Terraced town house in Lydd Town Centre. Spacious living over 3 floors, modern kitchen, master bedroom retreat, close to amenities and schools. Total size 1065 sqft. Ideal family home. Schedule a viewing now!

Council Tax band: TBD

Tenure: Freehold

EPC Energy Efficiency Rating: B

EPC Environmental Impact Rating: B

- Town House
- Three Bedroom
- Garden Space
- Generous Living Room
- Central Location
- Modern Kitchen



Hallway

Living Room

14' 5" x 13' 2" (4.40m x 4.01m)

Kitchen

9' 6" x 6' 7" (2.90m x 2.01m)

Landing

Bedroom

13' 2" x 10' 4" (4.01m x 3.15m)

Bedroom

8' 8" x 7' 5" (2.65m x 2.25m)

Bathroom

Bedroom

17' 5" x 13' 2" (5.32m x 4.01m)





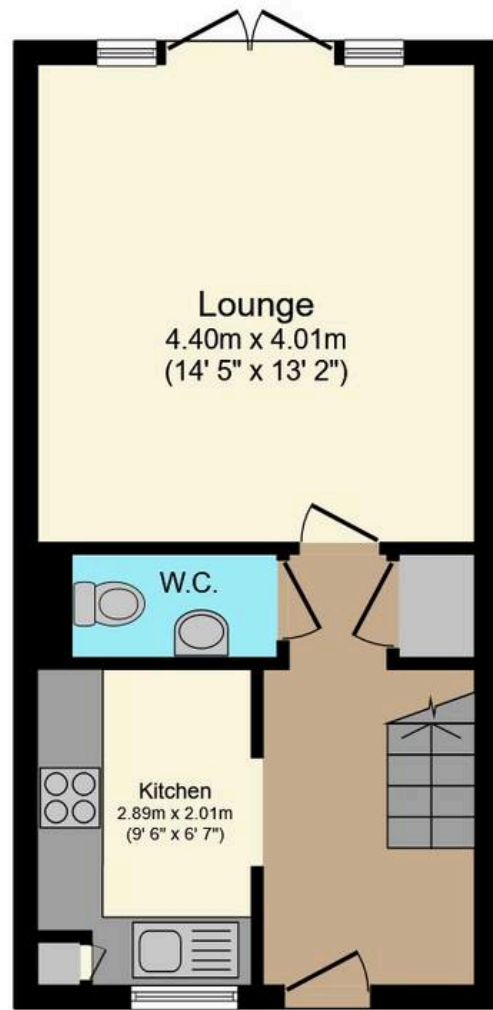

Ground Floor

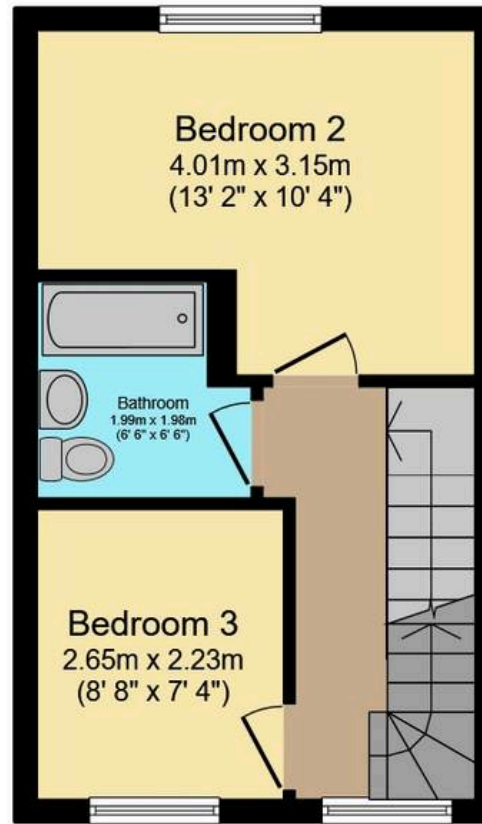

First Floor

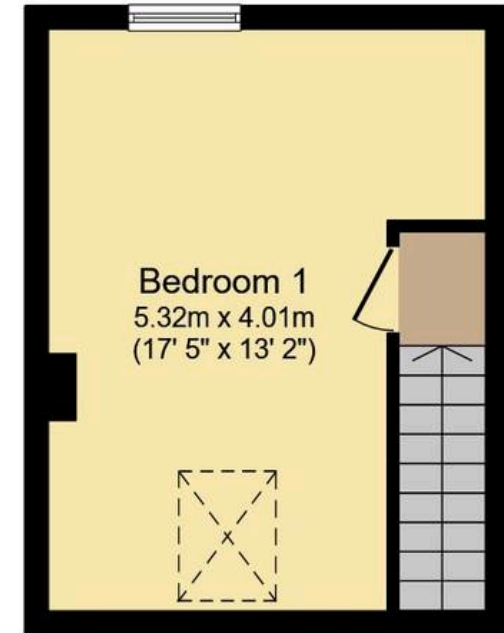

Second Floor

Total floor area 99.0 sq.m. (1,065 sq.ft.) approx

This floor plan is for illustrative purposes only. It is not drawn to scale. Any measurements, floor areas (including any total floor area), openings and orientation are approximate. No details are guaranteed, they cannot be relied upon for any purpose and they do not form part of any agreement. No liability is taken for any error, omission or misstatement. A party must rely upon its own inspection(s).

Powered by www.focalagent.com



Skippers Estate Agents – New Romney

55 High Street – TN28 8AH

01797 362898

newromney@skippers-ea.co.uk

skippers-ea.co.uk

Skippers