



Queens Road, Lydd

Romney Marsh

£395,000



Queens Road

Lydd, Romney Marsh

Charming 1800-built semi-detached house in central location offers period character with modern comforts. 4 bed, dining room, chef's kitchen, picturesque garden oasis. Efficient electric heating, close to amenities. Paradise retreat in heart of town, perfect blend of convenience and tranquillity.

Council Tax band: D

Tenure: Freehold

EPC Energy Efficiency Rating: D

EPC Environmental Impact Rating: D

- Period Home
- Open Fire Place
- Rype Views
- Central Location
- Dual Aspect Lounge
- Beautiful Kitchen



Entrance Porch

Hallway

Living Room

15' 11" x 9' 7" (4.85m x 2.93m)

Dinning Room

9' 9" x 11' 6" (2.96m x 3.50m)

Inner Hallway

Kitchen

15' 4" x 9' 8" (4.67m x 2.94m)

Wc

Landing

Bedroom

16' 2" x 10' 0" (4.94m x 3.05m)

Bedroom

14' 1" x 7' 3" (4.30m x 2.22m)

Bedroom

9' 1" x 9' 4" (2.76m x 2.85m)

Bathroom

6' 11" x 6' 11" (2.10m x 2.10m)

Bedroom

10' 0" x 28' 9" (3.06m x 8.77m)





Ground Floor

Approx. 54.3 sq. metres (584.8 sq. feet)



First Floor

Approx. 49.1 sq. metres (529.0 sq. feet)



Second Floor

Approx. 26.8 sq. metres (288.9 sq. feet)

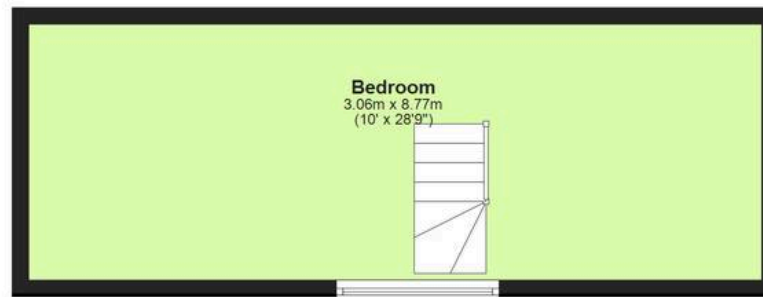

Total area: approx. 130.3 sq. metres (1402.7 sq. feet)

Plans are for layout purposes only and not drawn to scale, with any doors, windows and other internal features merely intended as a guide.
Plan produced using PlanUp.



Skippers Estate Agents - New Romney

55 High Street - TN28 8AH

01797 362898

newromney@skippers-ea.co.uk

skippers-ea.co.uk

Skippers