



Josephs Way, New Romney

£120,000

New Romney



Josephs Way

New Romney, New Romney

50% shared ownership Charming mid-terrace house in New Romney ideal for first-time buyers. Features 2 double bedrooms, modern bathroom, spacious kitchen, living room, ground floor WC, low maintenance garden, and allocated parking. Close to town centre, schools, shops, and beach. Don't miss this opportunity!

Council Tax band: B

Tenure: Leasehold

EPC Energy Efficiency Rating: B

EPC Environmental Impact Rating: B

- 50% Shared Ownership
- Two Double Bedrooms
- Mid Terrace House
- Large Living Room
- Spacious Kitchen
- Low Maintenance Garden
- Rent / Service charges applicable



Entrance Hall

Living Room

12' 6" x 15' 9" (3.80m x 4.81m)

Kitchen

8' 9" x 9' 9" (2.67m x 2.98m)

Wc

Landing

Bedroom

15' 10" x 9' 6" (4.83m x 2.89m)

Bedroom

8' 3" x 16' 10" (2.51m x 5.12m)

Bathroom



Ground Floor

Approx. 38.9 sq. metres (418.5 sq. feet)



First Floor

Approx. 38.9 sq. metres (418.5 sq. feet)

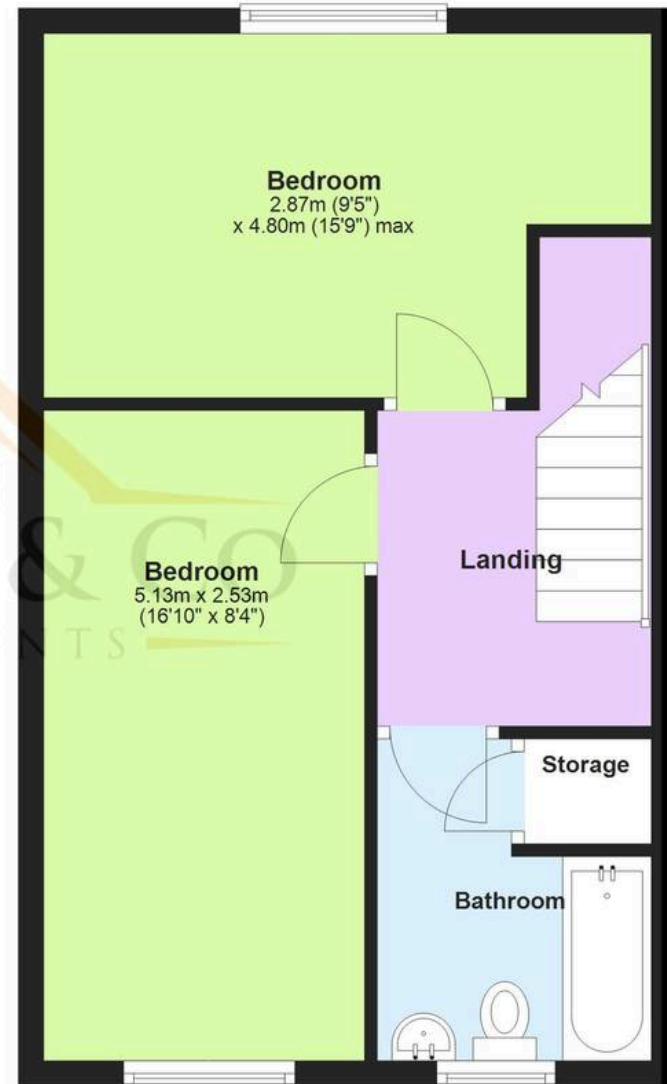

Total area: approx. 77.8 sq. metres (836.9 sq. feet)



Skippers Estate Agents - New Romney

55 High Street - TN28 8AH

01797 362898

newromney@skippers-ea.co.uk

skippers-ea.co.uk

Skippers