



53 Bradbridge Green, Ashford

Guide Price **£325,000**

Skippers

53 Bradbridge Green

Ashford, Ashford

A spacious 3-bedroom townhouse, benefitting from two bathrooms (one shower only), modern recently fitted kitchen, driveway parking, utility room, part converted garage creating a Cinema Room and all within close proximity of amenities, including walking distance to Great Chart Primary School. Council Tax band: D

Tenure: Freehold

- 3-bedroom townhouse
- Sought after position within Singleton
- Part converted garage to create a Cinema Room
- Low maintenance enclosed garden
- Two bathrooms (one shower only)
- Utility room on ground floor
- Driveway parking for 1 car
- Walking distance to local amenities including convenience store, Doctors Surgery & Great Chart Primary School



Hallway

Part glazed uPVC door to the front, stairs to the first floor with under-stairs storage, internal door to the garage, radiator, laminate wood flooring.

Garage

Electric roller door to the front, power sockets and lights, painted floor, door to Cinema Room and personnel door to the hallway.

Cinema Room

Laminate wood flooring.

Utility Room

Plumbing and space for washing machine, space for tumble dryer, work surfaces plus storage space, radiator, laminate wood flooring.

First Floor Landing

Stairs to the second floor, doors to each room, radiator, laminate wood flooring.

Kitchen/Diner

Fitted kitchen comprising matching wall and base units with work surfaces over, inset sink, free-standing cooker, plumbing and space for dishwasher, space for fridge/freezer. Wall mounted central heating boiler. Window to the rear and doors leading out to the garden. Tiled splash back and laminate wood flooring.



Lounge

Patio doors leading to the balcony, radiator, fitted carpet.

Shower Room

Comprising a square shower enclosure with opening door and electric shower, WC, wash basin, radiator, partly tiled walls and laminate wood flooring. Window to the front.





Second Floor Landing

Loft access, doors to each room, airing cupboard housing hot water cylinder, radiator, fitted carpet.

Bedroom 1

Window to the front, built-in wardrobes, radiator, fitted carpet.

Bedroom 2

Window to the rear, radiator, laminate wood flooring.

Bedroom 3

Window to the rear, radiator, vinyl flooring.

Bathroom

Comprising a bath with mixer taps, shower over and glass screen, WC, wash hand basin, towel radiator, extractor fan, tiled walls and laminate flooring.

Window to the front.







Ground Floor

Approx. 33.8 sq. metres (364.3 sq. feet)

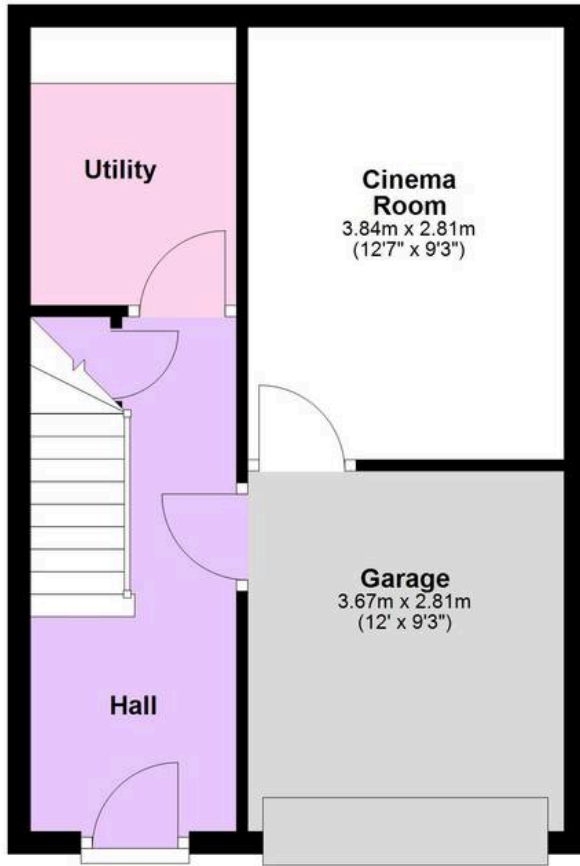

First Floor

Approx. 35.1 sq. metres (378.2 sq. feet)

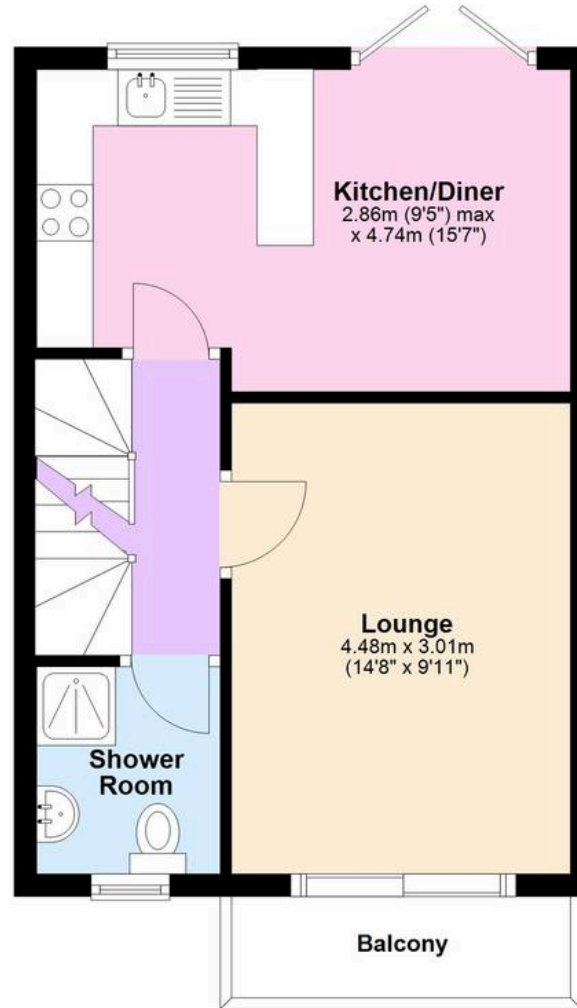

Second Floor

Approx. 36.6 sq. metres (394.4 sq. feet)

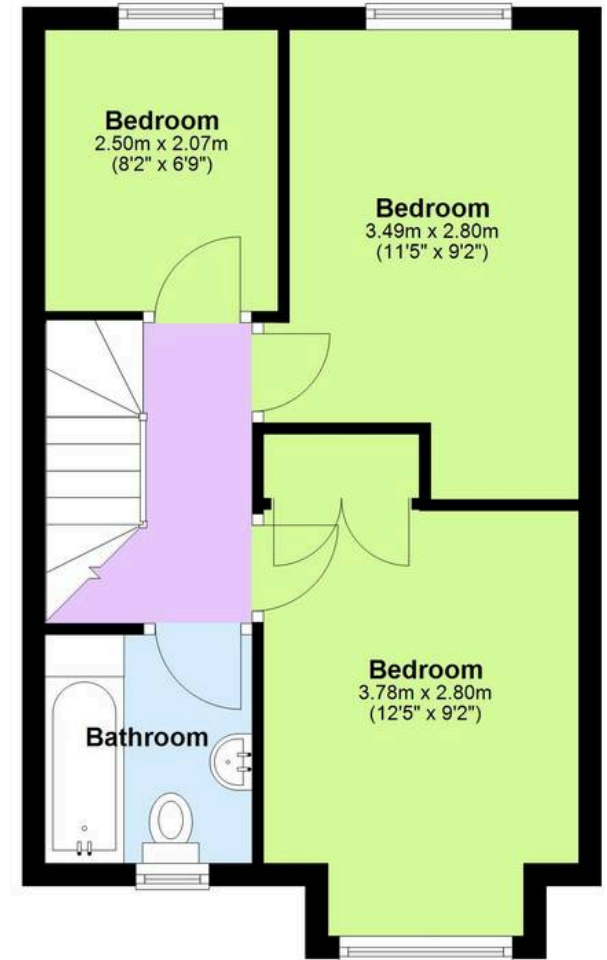

Total area: approx. 105.6 sq. metres (1136.8 sq. feet)



Skippers Estate Agents – Ashford

5 Kings Parade High Street, Ashford – TN24 8TA

01233 632383

ashford@skippers-ea.co.uk

skippers-ea.co.uk



