



10 Romney Crescent, Ashford  
£1,400 pcm



# 10 Romney Crescent

Ashford, Ashford

Charming 2-bed semi-detached house near town centre & train station. Modern interior, en-suite master bedroom, & private garden. Ideal blend of comfort & convenience.

Council Tax band: C

Tenure: Freehold

- Modern & well presented two bedroom semi-detached house
- On Street Permit Parking
- Two Double Bedrooms
- En-Suite Shower Room
- High Quality Finish
- Walking Distance To Town Centre & Ashford International Train Station















## Ground Floor

Approx. 37.1 sq. metres (399.6 sq. feet)

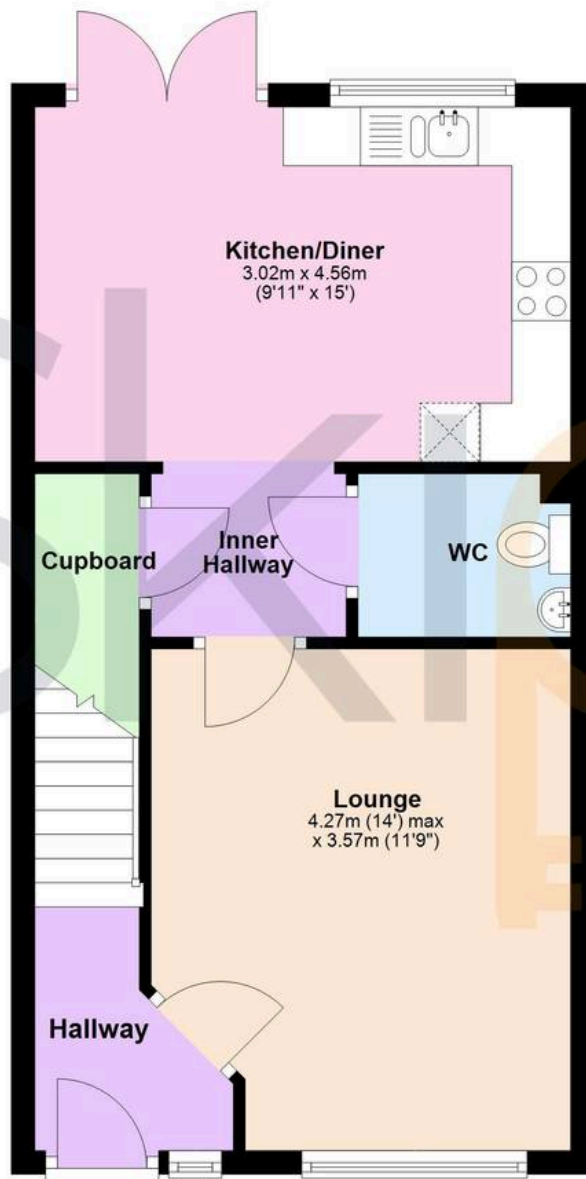

## First Floor

Approx. 40.9 sq. metres (440.3 sq. feet)



Total area: approx. 78.0 sq. metres (839.9 sq. feet)

Plans are for layout purposes only and are not drawn to scale, with any doors, windows and other internal features merely intended as a guide.

Plan produced using PlanUp.



## Skippers Estate Agents – Ashford

5 Kings Parade High Street, Ashford – TN24 8TA

01233 632383

[ashford@skippers-ea.co.uk](mailto:ashford@skippers-ea.co.uk)

[skippers-ea.co.uk](http://skippers-ea.co.uk)

Skippers

