



## 3 Town Farm Place, Ashford

Offers in Region of £385,000

Skippers



## 3 Town Farm Place

Ashford, Ashford

Beautiful 3-bed modern semi-detached home in Willesborough. Spacious kitchen, outdoor patio for al fresco dining, carport, and driveway parking for 3-4 vehicles. Close to Ashford Town and International Train Station.

Council Tax band: D

Tenure: Freehold

- Modern 3 Bedroom Semi-Detached Family Home
- 2017 Construction with Balance of NHBC guarantee
- Large Kitchen/Diner
- Located in Cul-de-sac within popular Willesborough
- En-suite to Master Bedroom
- Cloakroom
- Good access to Ashford Town & International Train Station
- Carport & Driveway Parking for 3-4 Vehicles
- Solar Panels





**Hallway**

Tiled flooring with large coat storage cupboard and stairs leading to first floor.

**Cloakroom**

With low level wc, pedestal wash hand basin with mixer tap and tiled splashback. Obscured window to side.

**Lounge**

16' 2" x 10' 2" (4.93m x 3.10m)

With window outlook to front.

**Kitchen/Diner**

17' 6" x 13' 9" (5.33m x 4.19m)

Range of cupboards and drawers beneath worksurfaces and additional wall mounted units, space and plumbing for washing machine and dishwasher, one and half bowl stainless steel sink with mixer tap and drainer, wall mounted boiler housed in cupboard, window and French doors to rear, 4 ring gas how with low level oven and extractor over, inset spotlights and locally tied walls.







### **Landing**

Carpeted, loft access, window to side and airing cupboard.

### **Bedroom**

11' 5" x 10' 6" (3.48m x 3.20m)

Carpeted with window to front and double built in wardrobes.

### **En-suite**

Low level wc, pedestal wash hand basin with mixer tap, tiled shower cubicle, extractor fan, locally tiled walls and towel radiator.

### **Bedroom**

13' 11" x 9' 0" (4.24m x 2.74m)

Carpeted, window to rear and double built in wardrobe.

### **Bedroom**

10' 7" x 8' 3" (3.23m x 2.51m)

Carpeted with window to rear and built in storage cupboard.

### **Family Bathroom**

White suite comprising low level wc, pedestal wash hand basin with mixer tap, panelled bath with shower screen, mixer tap and shower attachment, locally tiled walls, obscured window to front.









## Ground Floor

Approx. 49.6 sq. metres (534.3 sq. feet)

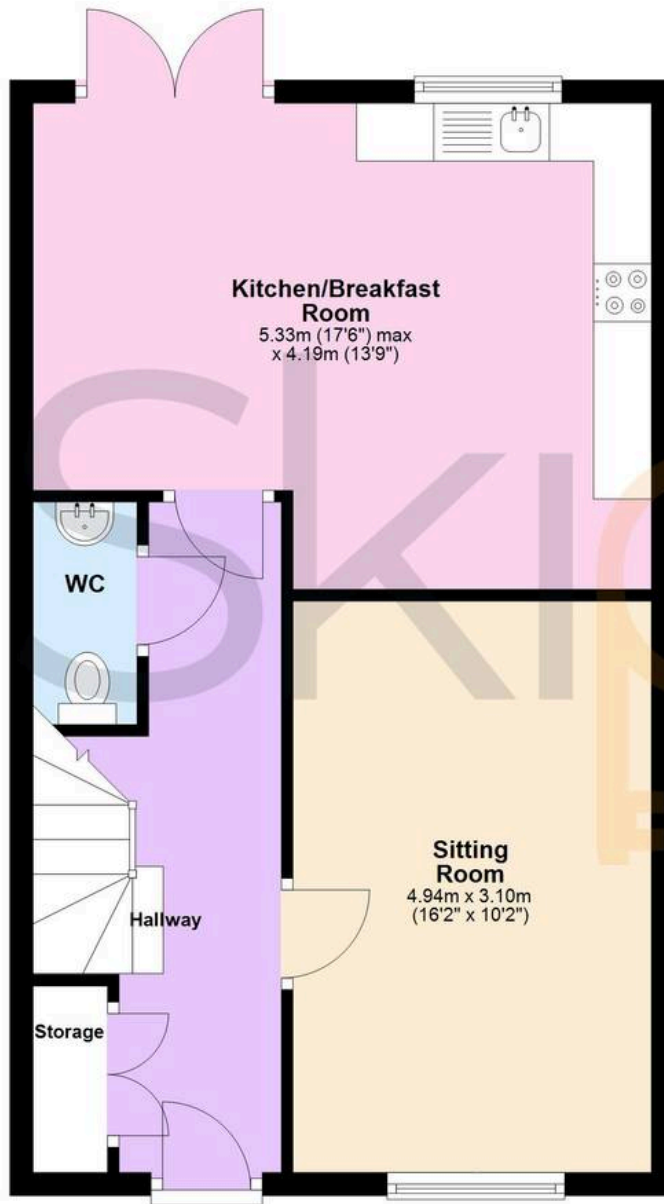

## First Floor

Approx. 46.0 sq. metres (494.6 sq. feet)

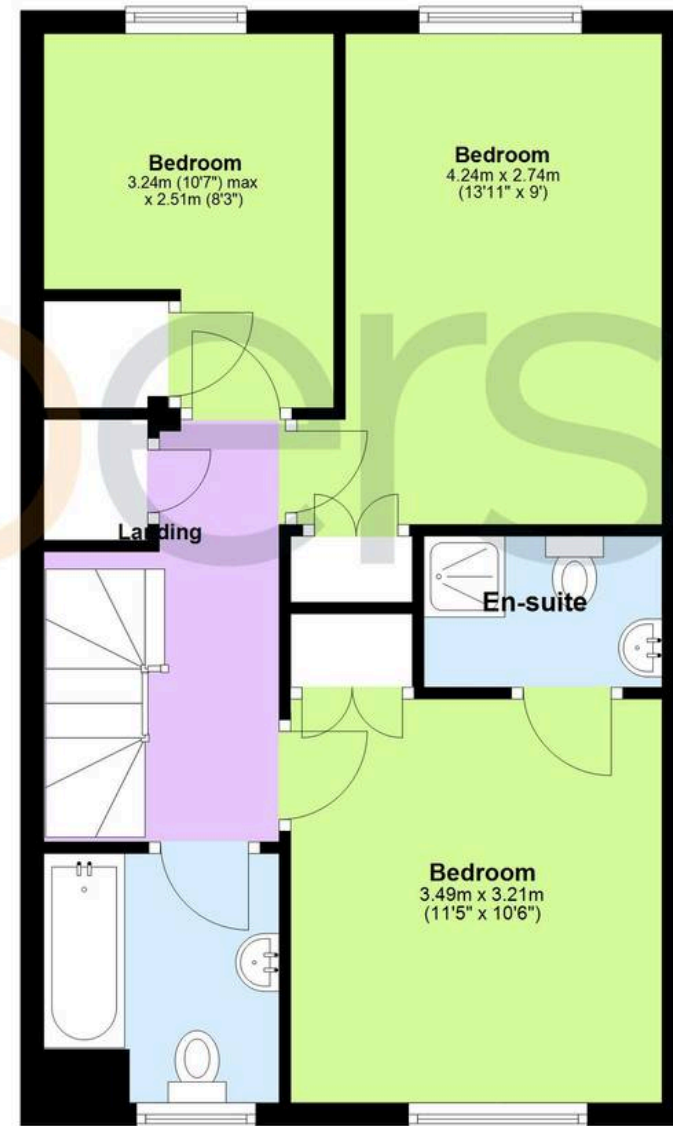

Total area: approx. 95.6 sq. metres (1028.9 sq. feet)





## Skippers Estate Agents – Ashford

5 Kings Parade High Street, Ashford – TN24 8TA

01233 632383

[ashford@skippers-ea.co.uk](mailto:ashford@skippers-ea.co.uk)

[skippers-ea.co.uk](http://skippers-ea.co.uk)

Skippers

