



143 Hythe Road, Ashford

Offers in Region of **£365,000**

Skippers

143 Hythe Road

Ashford, Ashford

Conveniently located 3-bed detached house on Hythe Road offers modern living with a spacious kitchen/diner, bay window lounge, 4-piece bath, large rear garden, and off-road parking. Plus, close to amenities and transport links, this property is a perfect family retreat with no onward chain.

Council Tax band: D

Tenure: Freehold

- NO ONWARD CHAIN
- Excellent Kitchen/Diner with bi-fold doors to rear garden
- 3 Bedroom Detached 1930's Built Family Home
- Large Rear Garden
- Convenient Hythe Road Location with good access to Ashford Town Centre & International Train Station
- Parking to Rear for 2 Vehicles with potential for extra spaces subject to extending
- Modern 4 piece Family Bathroom
- Lounge with Bay Window to front



Hallway

With stairs leading to first floor and access to lounge.

Lounge

15' 3" x 10' 9" (4.65m x 3.28m)

Carpeted with bay window to front and access through to kitchen/diner.

Kitchen/Diner

22' 8" x 14' 0" (6.91m x 4.27m)

Open plan Kitchen/Diner with range of gloss white fronted cupboards and drawers beneath work surfaces, 1 and half bowl ceramic sink with mixer tap and drainer, gas hob with extractor over and low level oven, space and plumbing for washing machine, breakfast bar, inset spotlights, bi-fold doors leading to rear garden.

Landing

Carpeted with airing cupboard and window to side.

Bedroom

12' 10" x 11' 1" (3.91m x 3.38m)

Carpeted with window to front and mirror fronted built in wardrobes.

Bedroom

15' 5" x 8' 0" (4.70m x 2.44m)

Carpeted with window to rear.

Bedroom

11' 7" x 5' 6" (3.53m x 1.68m)

Carpeted with window to rear.

Family Bathroom

White suite comprising low level wc, wash hand basin with mixer tap and vanity under, panelled bath with mixer tap and separate shower cubicle, towel radiator, locally tiled walls and skylight.

Agents Note

Please be advised pictures used were taken prior to the current tenants moving into the property.







Ground Floor

Approx. 48.1 sq. metres (518.0 sq. feet)



First Floor

Approx. 48.9 sq. metres (526.5 sq. feet)

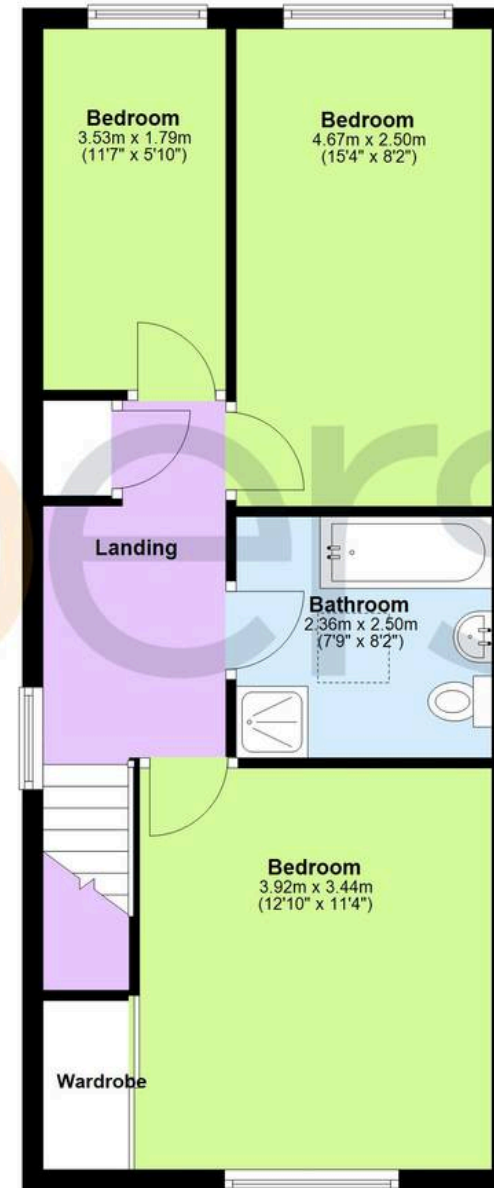

Total area: approx. 97.0 sq. metres (1044.5 sq. feet)



Skippers Estate Agents – Ashford

5 Kings Parade High Street, Ashford – TN24 8TA

01233 632383

ashford@skippers-ea.co.uk

skippers-ea.co.uk

Skippers

