



## 13 Badlesmere Close, Ashford

Offers in Region of £270,000

Skippers



## 13 Badlesmere Close

Ashford, Ashford

Convenient South Ashford location. Spacious 3 bed terraced family home with modern bathroom, cloakroom, lounge, and kitchen/diner. Low-maintenance rear garden with artificial lawn. Council Tax band: B

Tenure: Freehold

- Well Presented Spacious Mid Terraced Family Home
- South Ashford Location
- 3 Bedrooms
- Modern Fitted Kitchen/Diner
- Low Maintenance Rear Garden
- Ground Floor Cloakroom
- Good Access to Local Amenities & Public Transport Links to Ashford Town Centre
- Spacious Living Accommodation
- Pleasant Outlook



**Porch**

With window to front and door leading to Lounge.

**Lounge**

20' 0" x 11' 8" (6.10m x 3.56m)

Carpeted with d/g window to front, stairs to first floor, door through to inner hallway, radiator and TV point

**Kitchen/Diner**

13' 10" x 11' 7" (4.22m x 3.53m)

Range of fitted cupboards and drawers beneath work tops, d/g window to rear, wall mounted units, space and plumbing for washing machine and dishwasher, stainless steel sink with mixer tap and drainer, partially tiled walls and space for free standing cooker.

**Inner Hallway**

Under stairs cupboard housing meters, door leading to rear garden and access to kitchen and cloakroom.

**Cloakroom**

Low level wc, wash hand basin and obscured window to rear.

**Landing**

Carpeted with loft access and large airing cupboard.







### **Bedroom**

12' 0" x 12' 11" (3.66m x 3.94m)

With double glazed window to front, carpeted and radiator.

### **Bedroom**

12' 11" x 11' 7" (3.94m x 3.53m)

Double glazed window to rear, carpeted, cupboard housing wall mounted boiler and radiator.

### **Bedroom**

9' 0" x 7' 10" (2.74m x 2.39m)

With double glazed window to front and radiator.

### **Family Bathroom**

White suite comprising low level wc, pedestal wash hand basin with tiled splash back, panelled bath with shower over, obscure d/g window to rear, partially tiled wall and radiator.









## Ground Floor

Approx. 46.1 sq. metres (495.9 sq. feet)

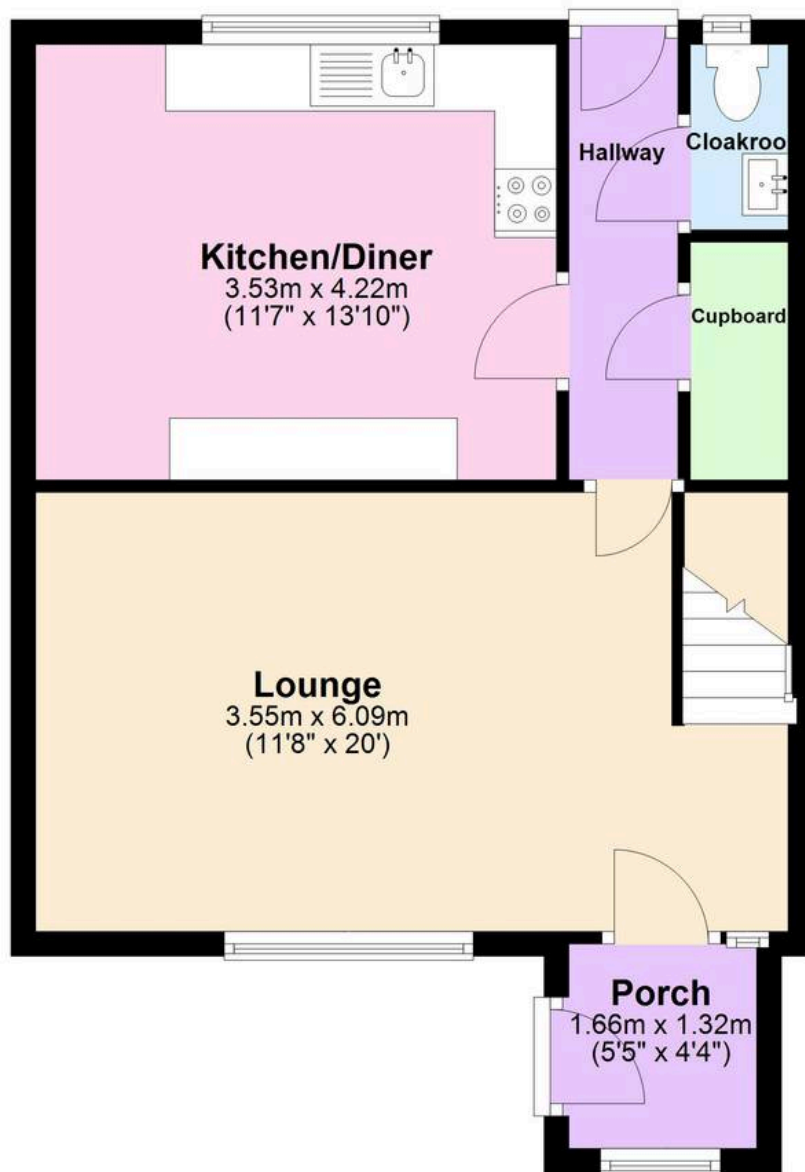

## First Floor

Approx. 46.5 sq. metres (500.4 sq. feet)

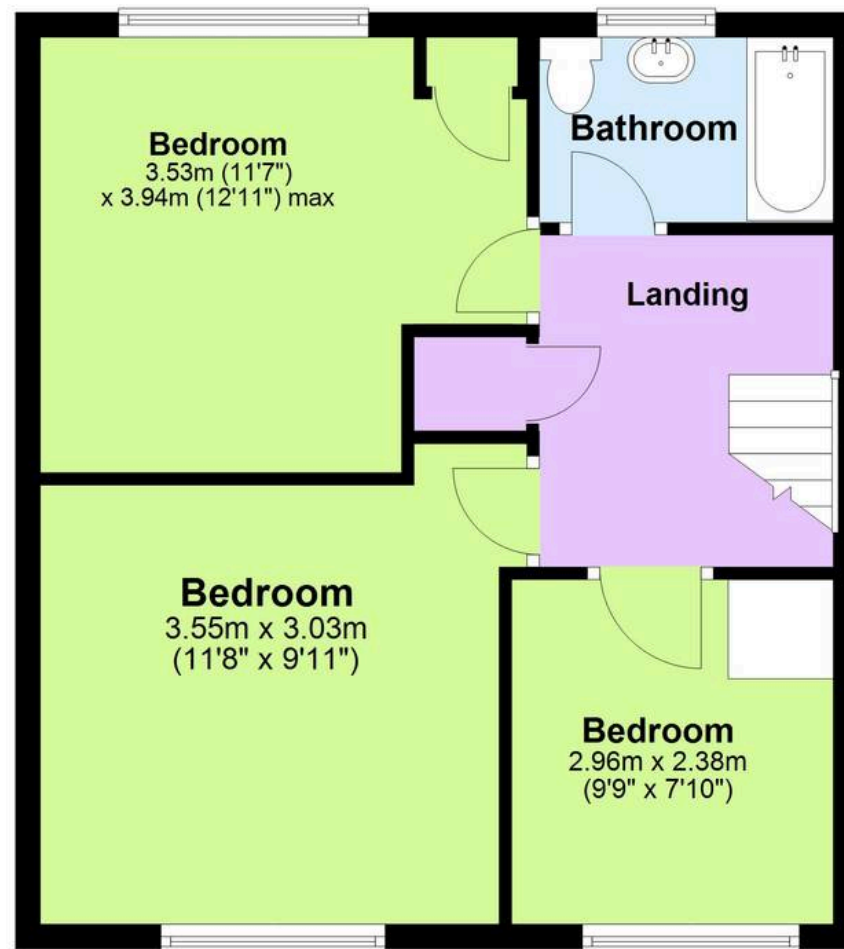

Total area: approx. 92.6 sq. metres (996.3 sq. feet)





## Skippers Estate Agents – Ashford

5 Kings Parade High Street, Ashford – TN24 8TA

01233 632383

[ashford@skippers-ea.co.uk](mailto:ashford@skippers-ea.co.uk)

[skippers-ea.co.uk](http://skippers-ea.co.uk)



