



St. Marys Road, Dymchurch

Romney Marsh

£650,000



St. Marys Road

Dymchurch, Romney Marsh

Stunning 6-bed Grade 2 det. home in Dymchurch. Recently renovated, spacious living areas, study, parking for 4 cars. Large garden & paddock. Ideal family home near shops, beach, restaurants.

Council Tax band: E

Tenure: Freehold

- Period Detached Home
- Spacious Flexible Accommodation
- Five/Six Bedrooms
- Three Reception Spaces
- Recently Renovated
- Large Garden with Seperate Paddock





Ground Floor

Approx. 83.9 sq. metres (903.4 sq. feet)



First Floor

Approx. 72.7 sq. metres (782.4 sq. feet)

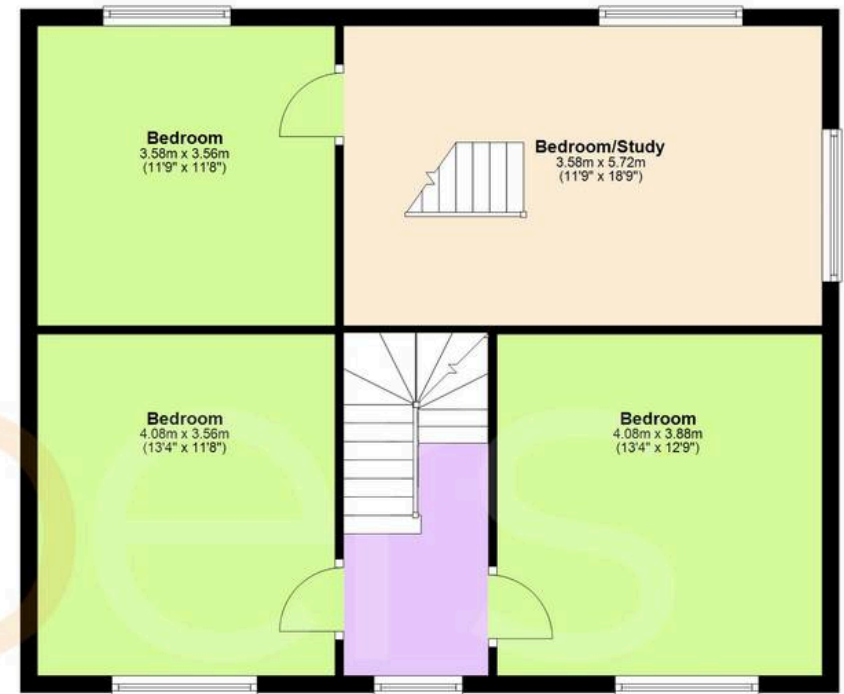

Second Floor

Approx. 26.1 sq. metres (280.4 sq. feet)

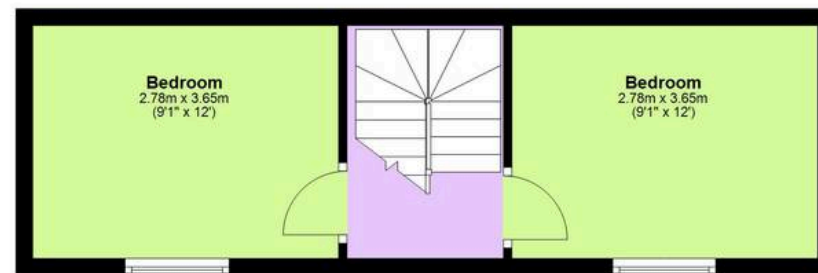

Total area: approx. 182.7 sq. metres (1966.3 sq. feet)



Skippers Estate Agents – New Romney

Andrew & Co, 55 High Street – TN28 8AH

01797 362898

newromney@skippers-ea.co.uk

skippers-ea.co.uk

Skippers