



40 Tadworth Road, Kennington
£295,000

Skippers

40 Tadworth Road

Kennington, Ashford

Charming 2-bed semi-detached bungalow in Kennington, Tadworth Road. Bright lounge, spacious kitchen/diner, 2 double bedrooms, private garden, driveway. Near amenities and transport links. NO CHAIN. Ideal for cosy living and entertaining.

Council Tax band: C

Tenure: Freehold

- NO ONWARD CHAIN
- Semi-Detached Bungalow
- 2 Double Bedrooms
- Lounge with Bay Window to Front
- Kitchen/Diner
- Block paved driveway for 2-3 vehicles
- Popular Kennington Location
- Close to many amenities including Hayesbank Doctors Surgery & Longacre Garden Centre
- Bathroom with White Suite



Hallway

Lounge

15' 1" x 10' 2" (4.60m x 3.10m)

Bay window to front and storage cupboard.

Kitchen/Diner

20' 7" x 8' 0" (6.27m x 2.44m)

Range of cupboards and drawers beneath worksurfaces with additional wall mounted units, door and window to rear, space and plumbing for washing machine and dishwasher, electric hob with extractor over, stainless steel sink with mixer tap and drainer, eye level oven, integrated fridge/freezer, storage cupboard.

Bedroom

12' 9" x 10' 2" (3.89m x 3.10m)

Window to rear and range of built in wardrobes.

Bedroom

10' 5" x 9' 2" (3.18m x 2.79m)

Carpeted with window to front.

Bathroom

White suite comprising low level wc, wash hand basin with mixer tap and vanity storage under, panelled bath with shower over and shower screen, obscured window to side, locally tiled walls.





Hallway

Lounge

15' 1" x 10' 2" (4.60m x 3.10m)

Bay window to front and storage cupboard.

Kitchen/Diner

20' 7" x 8' 0" (6.27m x 2.44m)

Range of cupboards and drawers beneath worksurfaces with additional wall mounted units, door and window to rear, space and plumbing for washing machine and dishwasher, electric hob with extractor over, stainless steel sink with mixer tap and drainer, eye level oven, integrated fridge/freezer, storage cupboard.

Bedroom

12' 9" x 10' 2" (3.89m x 3.10m)

Window to rear and range of built in wardrobes.

Bedroom

10' 5" x 9' 2" (3.18m x 2.79m)

Carpeted with window to front.

Bathroom

White suite comprising low level wc, wash hand basin with mixer tap and vanity storage under, panelled bath with shower over and shower screen, obscured window to side, locally tiled walls.





Energy Efficiency Rating

	Current	Potential
<i>Very energy efficient - lower running costs</i>		
(92+) A		
(81-91) B		88
(69-80) C	72	
(55-68) D		
(39-54) E		
(21-38) F		
(1-20) G		
<i>Not energy efficient - higher running costs</i>		
England, Scotland & Wales	EU Directive 2002/91/EC	

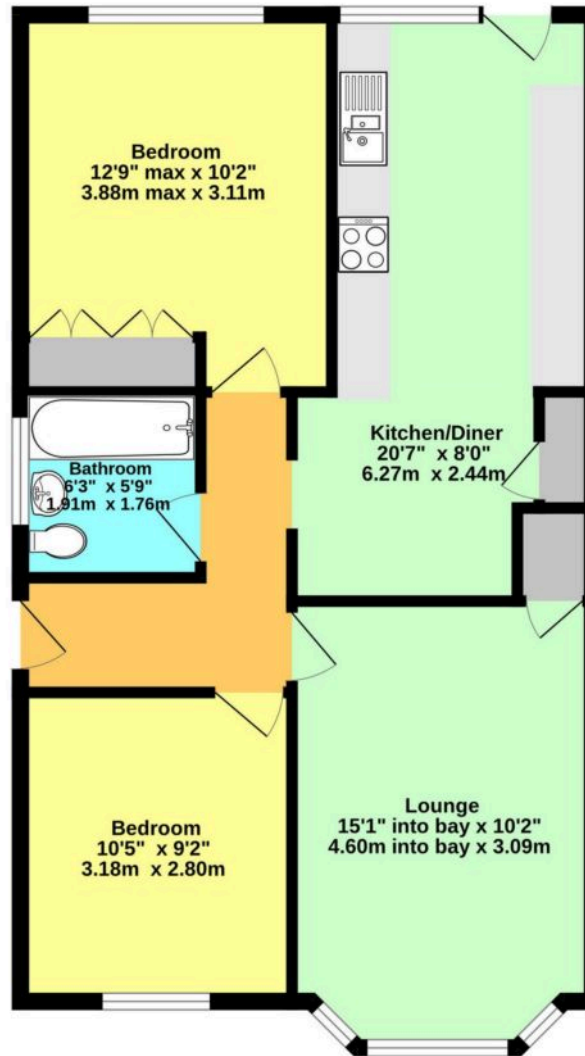

Whilst every attempt has been made to ensure the accuracy of the floorplan contained here, measurements of doors, windows, rooms and any other items are approximate and no responsibility is taken for any error, omission or mis-statement. This plan is for illustrative purposes only and should be used as such by any prospective purchaser. The services, systems and appliances shown have not been tested and no guarantee as to their operability or efficiency can be given.
Made with Metropix 5/2025





Skippers Estate Agents – Ashford

5 Kings Parade High Street, Ashford – TN24 8TA

01233 632383

ashford@skippers-ea.co.uk

skippers-ea.co.uk

Skippers

