



54 Waterside, Willesborough  
£350,000



## 54 Waterside

Willesborough, Ashford

Located in a quiet cul-de-sac within the Waterside development in Willesborough, this well-presented three-bedroom semi-detached home.

Council Tax band: B

Tenure: Freehold

- Located within the Waterside development in Willesborough
- Three-bedroom semi-detached home in a quiet cul-de-sac
- Spacious conservatory with solid, insulated tiled roof.
- Large rear garden



**Hallway**

uPVC door to the front. Stairs to the first floor, radiator, fitted carpet.

**Lounge**

16' 6" x 12' 5" (5.04m x 3.78m)

Fitted carpet, window to the front, radiator .  
Coal effect fire, doors leading to the kitchen/diner.

**Kitchen**

15' 8" x 7' 11" (4.78m x 2.42m)

Stone effect flooring. Matching wall and base units, space and plumbing for washing machine. Gas hob and oven. Stainless steel sink with mixer tap.

**Conservatory**

11' 4" x 8' 9" (3.45m x 2.66m)

Delightfully appointed conservatory with a solid, fully insulated tiled roof — offering the comfort and versatility of a true additional living space. Unlike traditional glass-roofed designs, this permanent-roof conservatory can be enjoyed all year round, making it ideal as a dining area, home office, or relaxing family room. Finished with a plastered ceiling and integrated lighting. The conservatory offers lovely views of the garden.

**Bedroom One**

14' 3" x 8' 10" (4.34m x 2.70m)

Window overlooking the front. Fitted carpet, fitted wardrobe, radiator.







### **Bedroom Two**

8' 10" x 8' 4" (2.70m x 2.53m)

Window to the rear. Fitted carpet, radiator.

### **Bedroom Three**

10' 11" x 6' 7" (3.32m x 2.01m)

Window to the front. Fitted carpet, radiator.

### **Bathroom**

6' 7" x 5' 0" (2.01m x 1.52m)

Low level w.c, hand basin. Roll top bath with shower. Obscured window to the rear.









Ground Floor

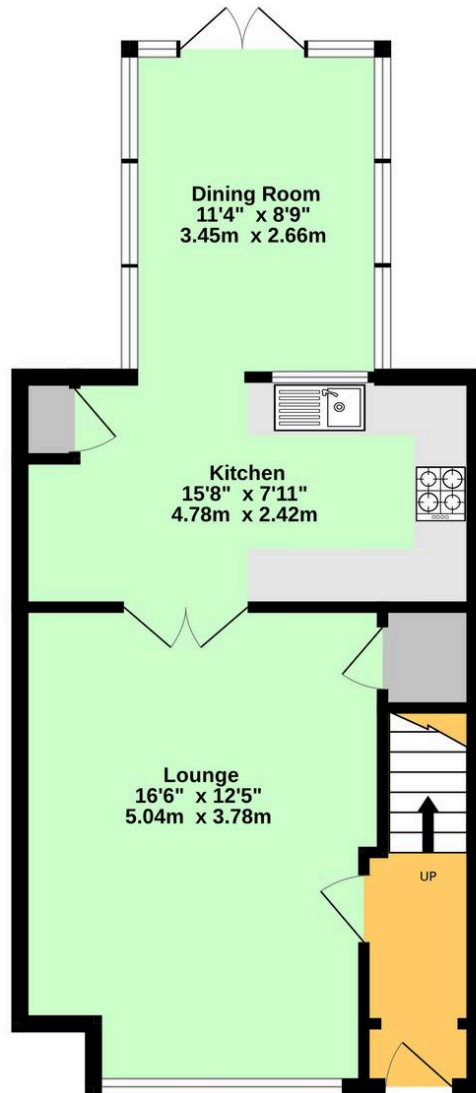

1st Floor

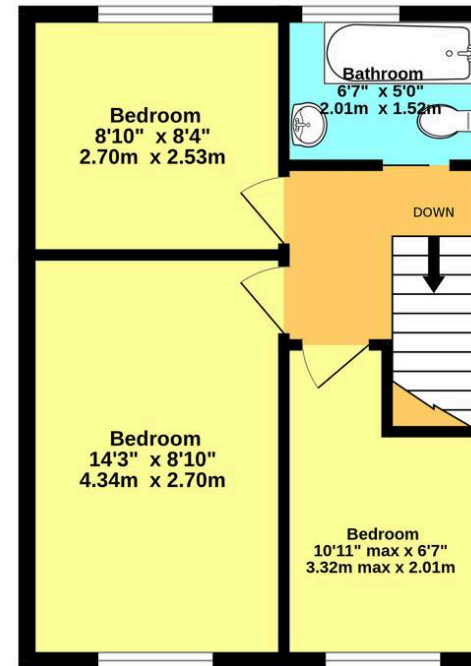





## Skippers Estate Agents – Ashford

5 Kings Parade High Street, Ashford – TN24 8TA

01233 632383

[ashford@skippers-ea.co.uk](mailto:ashford@skippers-ea.co.uk)

[skippers-ea.co.uk](http://skippers-ea.co.uk)

Skippers



