



## Flat 18, Betsom Place, 3 Leacon Road

Guide Price £200,000

Skippers



# Flat 18

Betsom Place, Ashford

An elegant one-bedroom apartment, located within a modern building built in 2020, overlooking Victoria Park and within close walking distance to Ashford International Station, enjoying modern fittings throughout, a large balcony and allocated parking.

No onward chain.

Council Tax band: B

Tenure: Leasehold

- Impressive one-bedroom apartment
- Modern kitchen with integrated appliances
- Elegant wooden flooring
- Large sliding glass doors leading to balcony
- Fitted wardrobes
- Contemporary modern bathroom
- Built in 2020
- Rooftop terrace with panoramic views
- Close walking distance to Ashford International Station & Victoria Park
- Allocated parking





**Hallway**

Doors to each room, large utility cupboard housing the washing machine and central heating boiler, radiator and wood flooring.

**Lounge/Diner**

14' 11" x 13' 10" (4.54m x 4.22m)

Large glass sliding doors leading to the balcony, radiator and wood flooring.

**Kitchen**

9' 6" x 7' 7" (2.89m x 2.32m)

A modern kitchen featuring wall and base units with work surfaces over, inset sink/drain, built-in appliances including an electric oven, hob, extractor hood, dishwasher and fridge/freezer. Tiled splashback and tiled flooring.

**Bedroom**

10' 8" x 13' 10" (3.25m x 4.22m)

Door leading to the balcony, fitted wardrobes, radiator and fitted carpet.

**Bathroom**

Modern bathroom comprising a bath with mixer taps, shower over and glass shower screen, WC, wash basin, towel radiator, extractor fan, shaver socket, wall tiling and tiled flooring.



## Second Floor

Approx. 52.4 sq. metres (564.0 sq. feet)

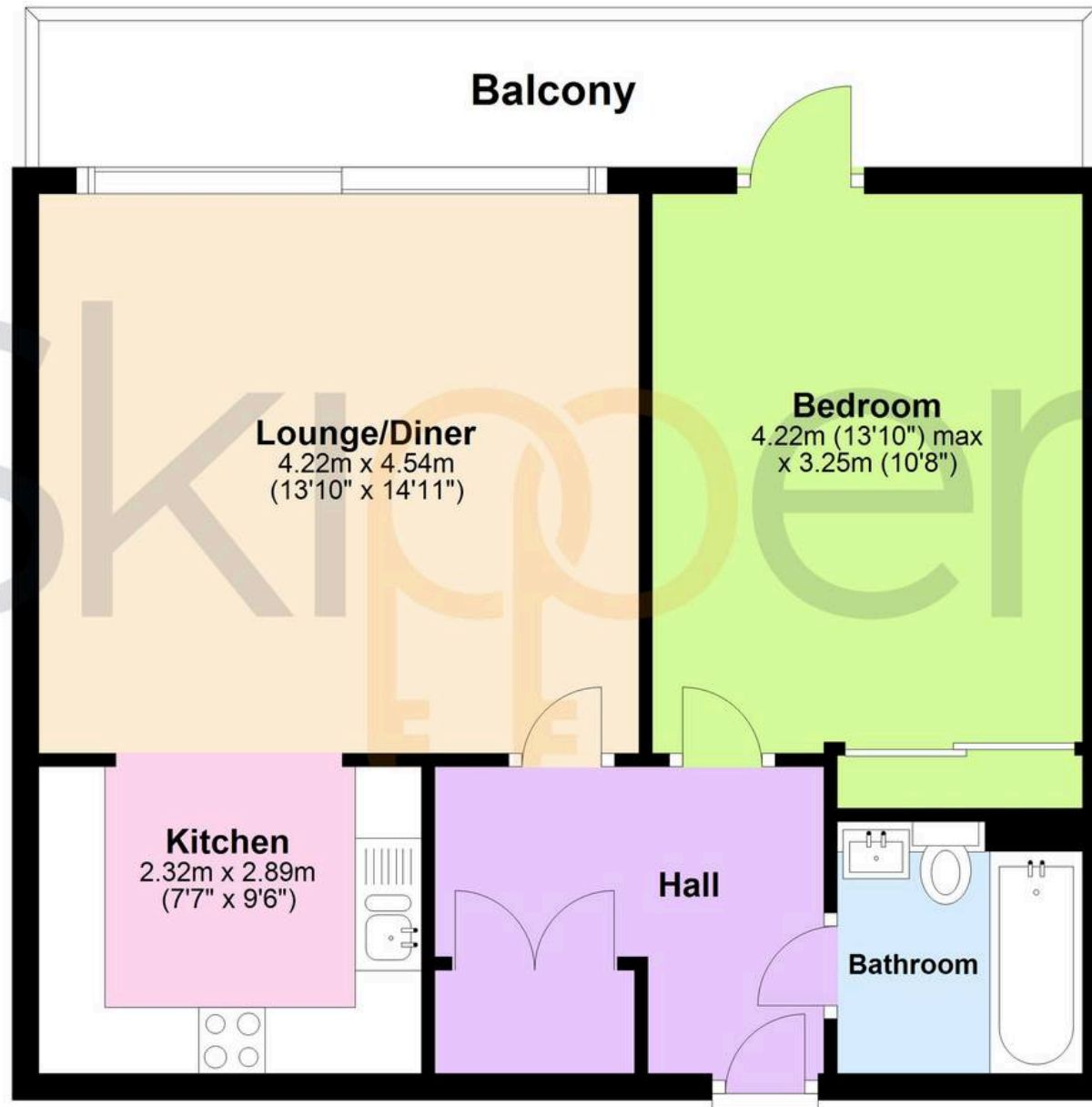





## Skippers Estate Agents – Ashford

5 Kings Parade High Street, Ashford – TN24 8TA

01233 632383

[ashford@skippers-ea.co.uk](mailto:ashford@skippers-ea.co.uk)

[skippers-ea.co.uk](http://skippers-ea.co.uk)

Skippers



