



17 Hadleigh Street, Kingsnorth

Guide Price £360,000

Skipper



# 17 Hadleigh Street

Kingsnorth, Ashford

Immaculate 3-bed townhouse in Bridgefield. Modern interiors, landscaped garden, car port. Ideal for commuters and families with easy access to amenities and transport links.

Council Tax band: D

Tenure: Freehold

- Immaculately Presented Semi-Detached Town House
- 3 Bedrooms
- Car Port & Driveway Parking
- En-suite & Dressing Room to Master Bedroom
- Desirable Bridgefield location close to amenities
- Landscaped Rear Garden
- Cloakroom
- Kitchen/Breakfast Room
- Easy access to Ashford International Station, local schools, and A2070 & M20





**Entrance Hall**

**Kitchen/Breakfast Room**

**Lounge**

13' 11" x 12' 5" (4.24m x 3.78m)

**Cloakroom**

**Landing**

**Family Bathroom**

**Bedroom**

13' 11" x 12' 6" (4.24m x 3.81m)

**Bedroom**

12' 0" x 7' 1" (3.66m x 2.16m)

**Bedroom**

21' 10" x 10' 6" (6.65m x 3.20m)

**En-suite**













**Approximate Gross Internal Area = 1095 sq ft - 102 sq m**

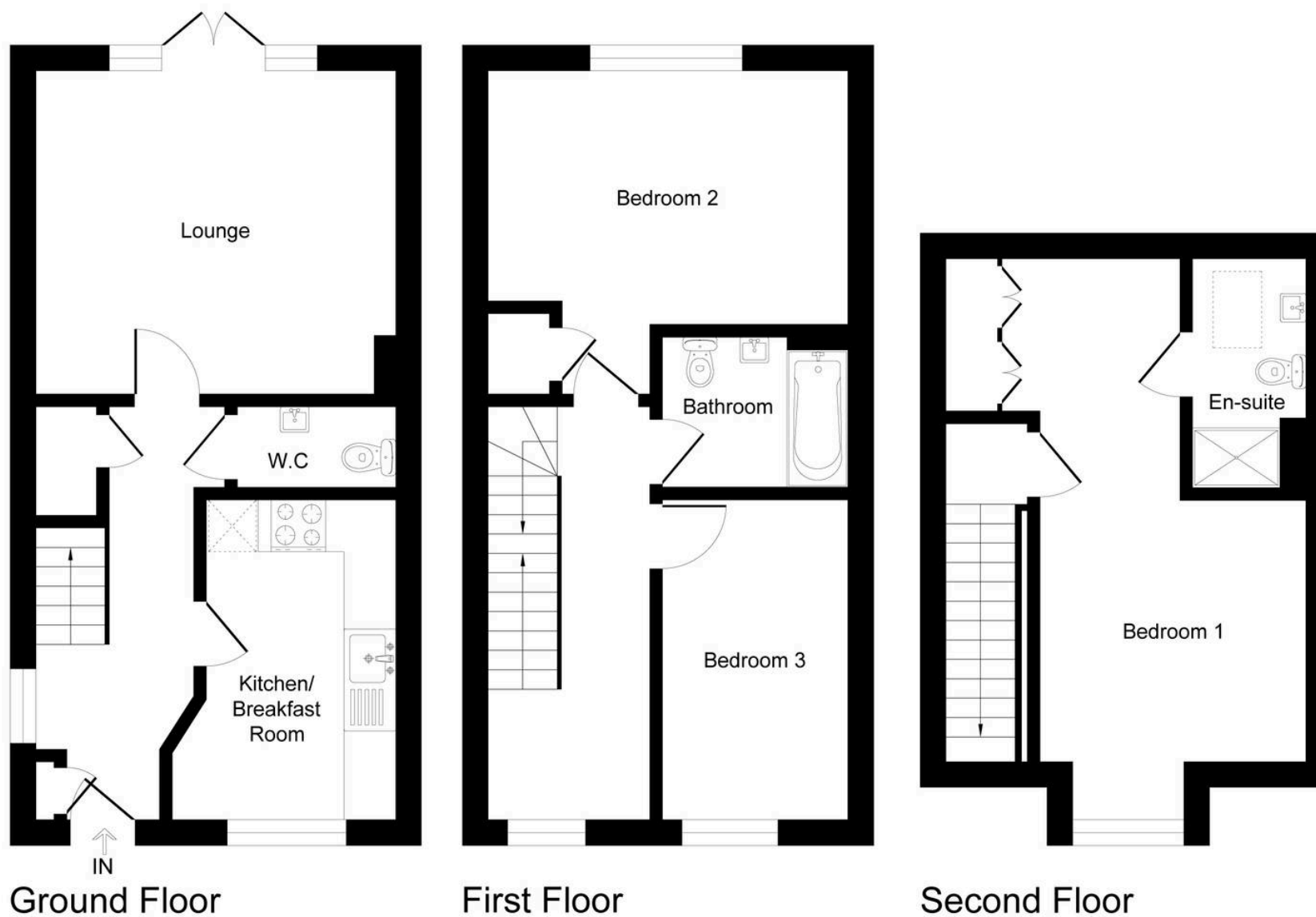

Although every attempt has been made to ensure accuracy, all measurements are approximate.  
This floorplan is for illustrative purposes only and not to scale.  
Measured in accordance with RICS Standards.





## Skippers Estate Agents – Ashford

5 Kings Parade High Street, Ashford – TN24 8TA

01233 632383

[ashford@skippers-ea.co.uk](mailto:ashford@skippers-ea.co.uk)

[skippers-ea.co.uk](http://skippers-ea.co.uk)

Skippers



