



51 White Willow Close, Ashford

Part Buy, Part Rent £85,000

Skippers

51 White Willow Close

Ashford, Ashford

A top floor 2-bedroom apartment, offered for sale under the shared ownership scheme, with a 50% share available at £85,000.

Council Tax band: B

Tenure: Leasehold

- Shared Ownership 50% Share £85,000
- Top Floor Apartment
- Spacious Large Design
- Two Double Bedrooms
- Modern Bathroom
- Allocated Parking Space
- Views Across Farmland
- Full Price £170,000



Entrance Hallway

Composite door from communal hallway, doors to each room, loft access, storage cupboard housing hot water cylinder, radiator and laminate wood flooring.

Lounge/Diner

15' 0" x 15' 0" (4.58m x 4.56m)

Windows to the front enjoying views across farmland, storage cupboard, radiator and laminate wood flooring.

Kitchen

9' 11" x 8' 0" (3.02m x 2.43m)

Comprising wall and base units with worksurfaces over, inset stainless steel sink/drain, built-in electric oven, 4-zone electric hob, extractor hood, plumbing and space for washing machine and dishwasher, space for fridge-freezer. Tiles splashback and flooring. Window to the front.

Bedroom 1

9' 8" x 13' 5" (2.94m x 4.10m)

Window to the rear, radiator and fitted carpet.

Bedroom 2

9' 10" x 11' 2" (3.00m x 3.40m)

Window to the rear, radiator and fitted carpet.

Bathroom

Comprising a shower bath with mixer taps and electric shower over plus glass shower screen, WC, wash basin with storage beneath, towel radiator, extractor fan, tiled walls and flooring.





Top Floor

Approx. 67.1 sq. metres (722.3 sq. feet)

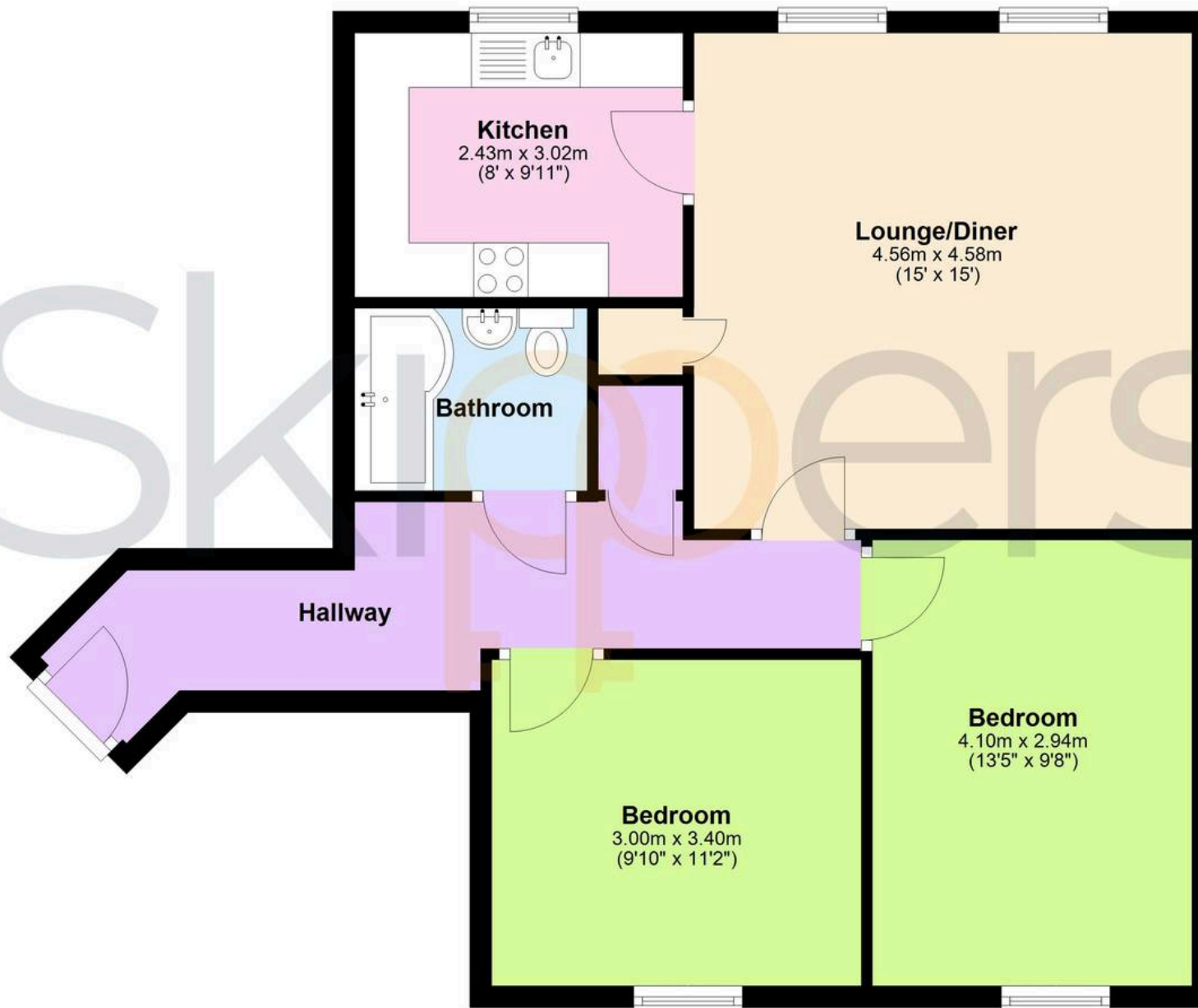

Total area: approx. 67.1 sq. metres (722.3 sq. feet)



Skippers Estate Agents – Ashford

5 Kings Parade High Street, Ashford – TN24 8TA

01233 632383

ashford@skippers-ea.co.uk

skippers-ea.co.uk



