



Flat 9, Bank House Mountfield Road, New Romney  
£125,000

## Flat 9

Bank House Mountfield Road, New Romney

Charming 1-bed flat with open plan living, well-appointed kitchen, tranquil bedroom with en-suite, close to amenities. Tastefully decorated, flooded with natural light, perfect for urban living.

- Light and bright open plan living.
- Just a short walk from local amenities
- En-suite bathroom
- One double bedroom





This charming 1 bedroom flat is a delightful blend of comfort and modern living. The property boasts a light and bright open plan living area, creating a welcoming space that is perfect for relaxation and entertaining alike. The well-appointed kitchen seamlessly connects to the cosy living room, providing a versatile space for every-day living.

The bedroom is a tranquil retreat, offering ample space and privacy. With an en-suite bathroom, this room provides the perfect space to relax.

Located just a short walk from local amenities, this flat offers the convenience of urban living with the tranquillity of a residential area. Whether you are looking to explore the local shops and cafes or enjoy a leisurely stroll to the nearby beach, this property is perfectly situated for those seeking a balanced lifestyle.

The flat is tastefully decorated throughout, with neutral tones and contemporary finishes creating a stylish and inviting atmosphere. Large windows flood the space with natural light, enhancing the sense of space and airiness in the property.

This property is a rare find, offering the perfect combination of comfort, convenience, and style. Whether you are a first-time buyer looking for a cosy home or a professional seeking a modern urban retreat, this flat is sure to impress. Don't miss the opportunity to make this exquisite property your own. Contact us today to schedule a viewing and experience the beauty of this exceptional home first-hand.

- Light and bright open plan living.
- Just a short walk from local amenities
- En-suite bathroom
- One double bedroom

**Entrance hall**

**Open plan living space**

16' 3" x 10' 4" (4.96m x 3.15m)

Modern, bright open plan living and kitchen area.

**Wc**

**Bedroom**

10' 5" x 10' 4" (3.18m x 3.15m)

**En-suite**



OFF STREET







## Ground Floor

Approx. 23.6 sq. metres (253.6 sq. feet)

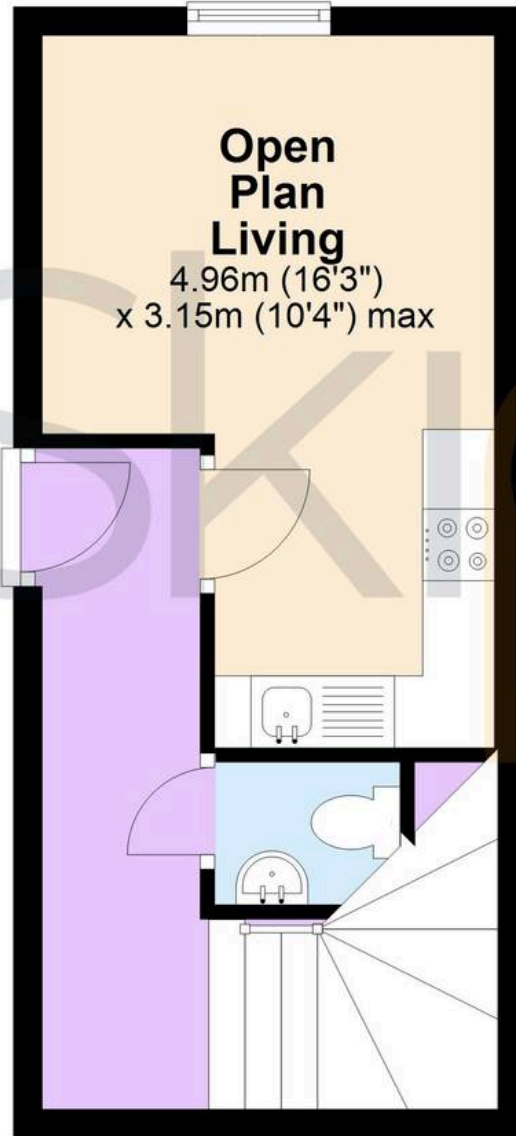

## First Floor

Approx. 24.3 sq. metres (262.0 sq. feet)

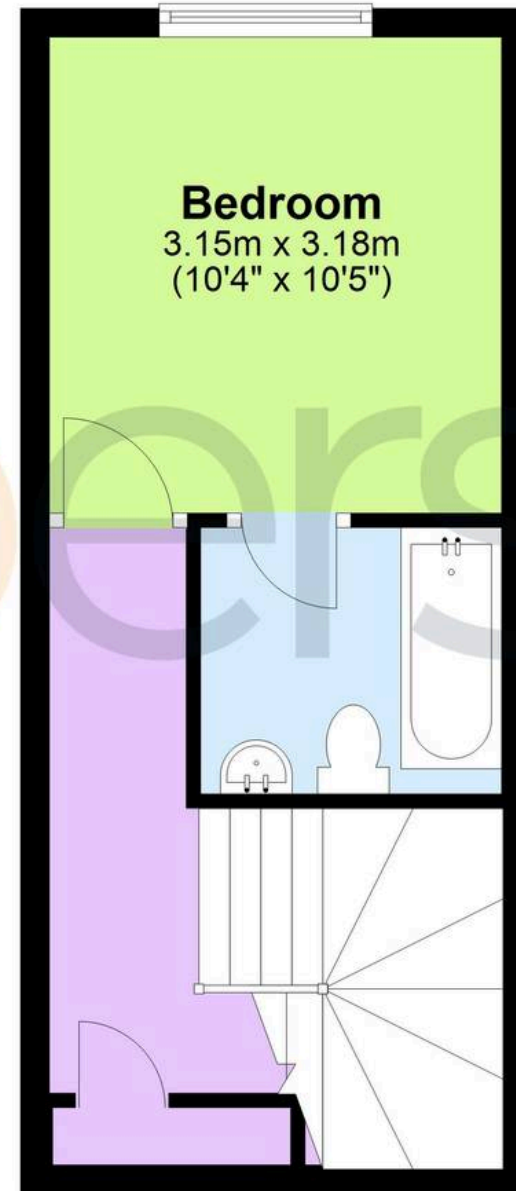

Total area: approx. 47.9 sq. metres (515.5 sq. feet)



## Skippers Estate Agents Cheriton/Folkestone

30 High Street, Cheriton - CT19 4ET

01303 279955

[cheriton@skippers-ea.co.uk](mailto:cheriton@skippers-ea.co.uk)

[skippers-ea.co.uk](http://skippers-ea.co.uk)

The logo for Skippers Estate Agents, featuring the word "Skippers" in a white, sans-serif font. The letter "i" is stylized as a key, with the top bar of the "i" being the key's head and the stem of the "i" being the key's shaft. The key is colored orange and yellow.