



4 Apsley House Chart Road, Ashford

Guide Price £220,000

Skippers

4 Apsley House Chart Road

Ashford, Ashford

A stylish two-bedroom apartment in a Grade II listed building, just a short walk from the Town Centre. Featuring a spacious Open-Plan Living Room with vaulted ceiling, modern kitchen and bathroom, with allocated parking. An ideal first home or investment purchase.

Council Tax band: B

Tenure: Leasehold

- Situated within a charming Grade II listed building
- Within easy walking distance of the town centre
- Spacious open-plan living room/kitchen with vaulted ceiling
- Beautiful sash bay windows in keeping with the property's period character
- Modern kitchen with fitted appliances
- Two well-proportioned double bedrooms
- Stylish contemporary bathroom
- Recently decorated throughout
- Allocated parking for one car
- Ideal for first-time buyers, downsizers or buy-to-let investors



Hallway

With doors leading to each room, radiator, door entry phone and laminate wood flooring.

Open-Plan Lounge/Kitchen

20' 6" x 19' 6" (6.25m x 5.95m)

A bright and spacious open-plan living room with sash windows, radiators and laminate wood flooring. A modern fitted kitchen comprises a range of wall and base units with worksurfaces over, inset sink/drain, built-in electric oven, hob, extractor hood, washing machine and fridge/freezer.

Bedroom 1

12' 1" x 10' 2" (3.68m x 3.09m)

With sash windows, radiator and laminate wood flooring.

Bedroom 2

11' 1" x 7' 3" (3.37m x 2.22m)

Window, radiator and laminate wood flooring.

Bathroom

A modern bathroom comprising a bath with mixer taps, shower attachment and glass screen, WC, wash basin, extractor fan, illuminated mirror, towel radiator, partly tiled walls (fully tiled around the bath) and laminate wood flooring.





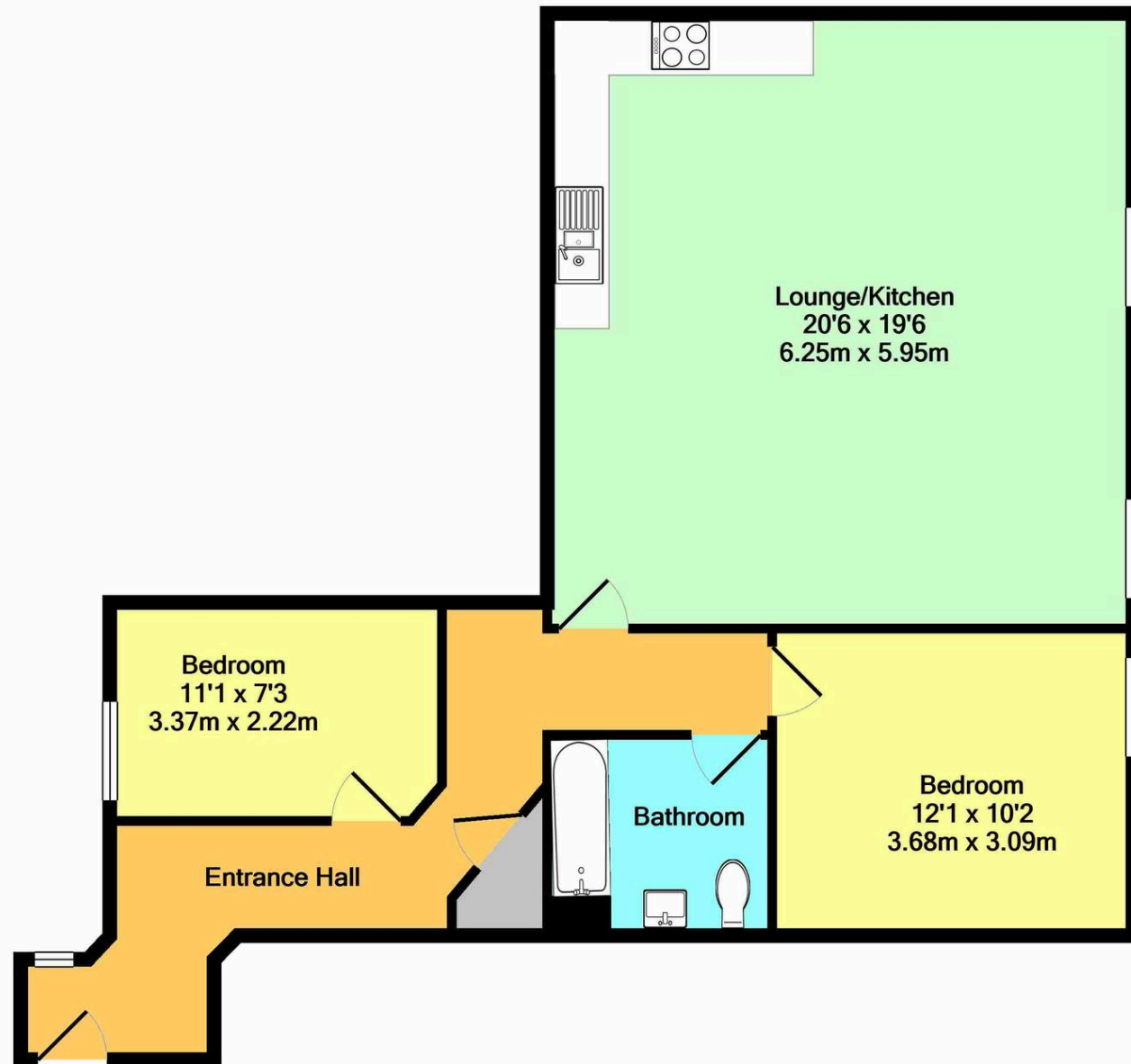

Whilst every attempt has been made to ensure the accuracy of the floor plan contained here, measurements of doors, windows, rooms and any other items are approximate and no responsibility is taken for any error, omission, or mis-statement. This plan is for illustrative purposes only and should be used as such by any prospective purchaser. The services, systems and appliances shown have not been tested and no guarantee as to their operability or efficiency can be given

Made with Metropix ©2020



Skippers Estate Agents – Ashford

5 Kings Parade High Street, Ashford – TN24 8TA

01233 632383

ashford@skippers-ea.co.uk

skippers-ea.co.uk

Skippers

