



20 Hazel Heights, Ashford

Offers in Region of £650,000

Skippers

20 Hazel Heights

Ashford

Exceptional four-bed detached home in Orchard Heights, Ashford. Extended, high-spec finish, open-plan living, double garage, landscaped garden, ideal for families and commuters.

Council Tax band: F

Tenure: Freehold

- Exceptional four-bedroom detached family home in the sought-after Orchard Heights development, Ashford.
- Extended and beautifully upgraded throughout to a high standard.
- Generous block-paved driveway providing ample off-road parking for several vehicles.
- Detached double garage with power, lighting and roof storage.
- Stunning open-plan kitchen, dining and family room with roof lanterns, bi-folding doors and premium integrated appliances.
- Spacious dual-aspect sitting room with patio doors opening directly onto the rear garden.
- Dedicated study with bespoke fitted office furniture, ideal for home working.
- Master bedroom suite with stylish en-suite shower room.
- Landscaped rear garden with composite decking, Italian aluminum louvered pergola, summer house and workshop.
- Excellent location close to schools, shops, transport links and Ashford International Station.



Hallway

A welcoming entrance is created through a double glazed front door with matching side window, allowing natural light to flood the hallway. Finished with luxury vinyl flooring, the spacious reception hall offers excellent practicality with a bespoke built-in coat and shoe cupboard together with generous under-stairs storage.

Cloakroom

Elegantly appointed with luxury vinyl flooring, a contemporary wash hand basin with vanity storage, low-level WC and a heated towel radiator.

Study

Ideal for home working, the dedicated office features bespoke fitted office furniture, luxury vinyl flooring and a contemporary Vasco designer radiator, providing a comfortable and stylish working environment.

Lounge

A beautifully proportioned dual-aspect reception room enjoying an abundance of natural light from double glazed windows to both the front and rear elevations. Patio doors open directly onto the rear garden, creating an effortless connection between indoor and outdoor living. Luxury vinyl flooring flows throughout, complemented by contemporary Vasco radiators, including a space-saving wall-mounted design. Television and telephone points complete this superb family living space.





Kitchen / Diner

Undoubtedly the heart of the home, this extended kitchen and dining space is designed for family living and entertaining. Flooded with natural light from two roof lanterns, rear windows and bi-folding doors with integrated blinds, it opens directly onto the garden. The bespoke kitchen features extensive cabinetry, deep drawers and Black Galaxy granite worktops, plus a breakfast bar and Bosch integrated appliances, including a microwave, double oven, fridge/freezer, additional freezer, dishwasher, washing machine, induction hob with gas wok burner, warming drawer and space for a wine cooler. Marble tiled flooring, LED lighting and a contemporary radiator complete the room.

Stairs and landing

A striking glass balustrade staircase leads to the first floor, finished with a quality stair runner. Plush carpeting continues throughout the landing and bedrooms, creating a luxurious feel. The loft is partially boarded and benefits from a fitted ladder, lighting and power, housing the boiler and hot water tank. An additional airing cupboard provides excellent linen storage.





Master Bedroom

A generous principal suite overlooking the rear of the property, offering ample space for a king-size bed and additional bedroom furniture. Finished with plush carpeting, television and telephone points, double glazed windows and a contemporary wall mounted space saving radiator.

En-suite

Beautifully appointed with part tiled walls and luxury vinyl flooring, comprising a large walk-in shower with rainfall shower head and separate handheld attachment, vanity wash basin with storage, low-level WC, heated towel radiator and shaver point.

Bedroom

A spacious double bedroom featuring plush carpeting, radiator, double glazed window and a useful built-in storage cupboard.

Bedroom

Another generous double bedroom with plush carpeting, radiator and double glazed window.

Bedroom

Currently arranged as an impressive dressing room, complete with fitted mirrored wardrobes, although equally suited as a fourth double bedroom or nursery.







Ground Floor



1st Floor

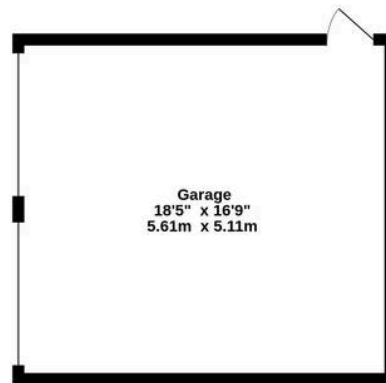
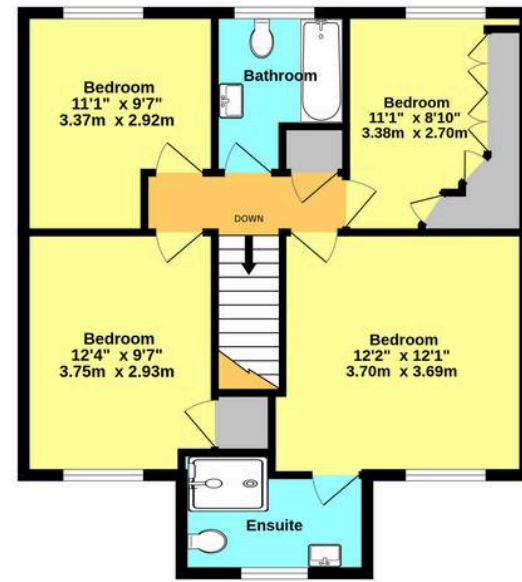

Whilst every attempt has been made to ensure the accuracy of the floorplan contained here, measurements of doors, windows, rooms and any other items are approximate and no responsibility is taken for any error, omission or mis-statement. This plan is for illustrative purposes only and should be used as such by any prospective purchaser. The services, systems and appliances shown have not been tested and no guarantee as to their operability or efficiency can be given.
Made with Metropix ©2026



Skippers Estate Agents – Ashford

5 Kings Parade High Street, Ashford – TN24 8TA

01233 632383

ashford@skippers-ea.co.uk

skippers-ea.co.uk



